

# Butt Weld Fittings

## Standards

**Standard Grades** according to ASTM A / ASME SA 403, 304/L and 316/L (dual marked and certified), to ASME B16.9, annealed and quenched, bevelled ends to ASME B16.25, hardness to NACE MR0175 / ISO 15156, IC to ASTM A262E and PMI tested. With certificate to EN 10204/3.1.

**Special Grades** according to ASTM A815 in grades SAF2205 / UNS S31803, SAF2507 / UNS S32750, ANSI B16.9, annealed and quenched, bevelled ends to ANSI B16.25, hardness to NACE MR0175 / ISO 15156, IC to ASTM A262E (G48A for SAF 2507) and PMI tested. With certificate to EN 10204/3.1.

**Stainless steel fittings** according to ASTM A403 .

Class WP (Wrought pipe) fittings are manufactured to the dimensional requirements of ANSI B16.9 or ANSI B16.28. Class CR (Corrosion resistant) fittings are manufactured to the dimensional requirements end pressure ratings of MSS SP-43.

### Summary of classes

Grade	Class	Construction	Nondestructive examination
CR	-	Welded	None
WP	S	Seamless	None
WP	W	Welded	Radiography/X-ray or ultrasonic
WP	WX	Welded	Radiography/X-ray
WP	WU	Welded	Ultrasonic

### Long Radius Elbows 45°



**FPWE**

### Long Radius Elbows 90°

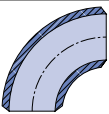

**FPWE**

### Short Radius Elbows 90°

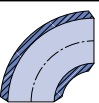

**FPWE**

### Equal Tees

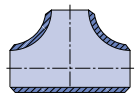

**FPWTE**

### Reducing Tees

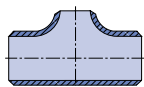

**FPWTR**

### Concentric Reducers

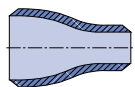

**FPWRC**

### Eccentric Reducers

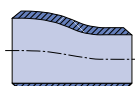

**FPWRE**

### Stub Ends - Type A (Short Length)

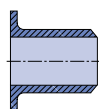

**FPWSE**

### End Caps

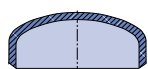

**FPSEC**

# Butt Weld Fittings

## Dimensions

ASME B16.9, B16.28

### Long and Short Radius Elbows

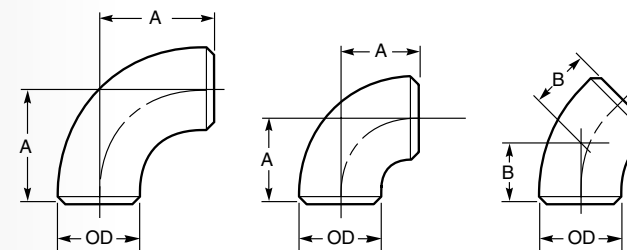

### Straight Tees

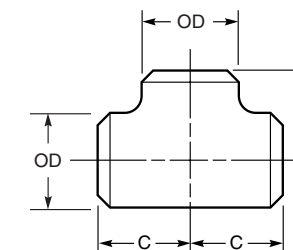

Nominal Pipe Size (NPS)		Outside Diameter at Bevel OD	Centre-to-End			
			90 Elbows A		45 Elbows B	
in	mm		Long Radius	Short Radius	Long Radius	Short Radius
1/2	15	21.3	38	-	16	-
3/4	20	26.7	29	-	11	-
1	25	33.4	38	25	22	10
1-1/4	32	42.2	48	32	25	13
1-1/2	40	48.3	57	38	29	16
2	50	60.3	76	51	35	21
2 1/2	65	73	95	64	44	26
3	80	88.9	114	76	51	32
3 1/2	90	101.6	133	89	57	37
4	100	114.3	152	102	64	42
5	125	141.3	190	127	79	53
6	150	168.3	229	152	95	63
8	200	219.1	305	203	127	84
10	250	273	381	254	159	105
12	300	323.8	457	305	190	126
14	350	355.6	533	356	222	147
16	400	406.4	610	406	254	168
18	450	457	686	457	286	189
20	500	508	762	508	318	210
22	550	559	838	559	343	232
24	600	610	914	610	381	253
26	650	660	991	660	405	274
28	700	711	1067	711	438	295
30	750	762	1143	762	470	316
32	800	813	1219	813	502	338
34	850	864	1295	864	533	358
36	900	914	1372	914	565	379
38	950	965	1448	965	600	400
40	1000	1016	1524	1016	632	421
42	1050	1067	1600	1067	660	442
44	1100	1118	1676	1118	695	463
46	1150	1168	1753	1168	727	484
48	1200	1219	1829	1219	759	505

Nominal Pipe Size (NPS)		Outside Diameter at Bevel OD	Centre-to-End	
			Straight Tees	
in	mm		C	M <sup>(1)</sup>
1/2	15	21.3	25	25
3/4	20	26.7	29	29
1	25	33.4	38	38
1-1/4	32	42.2	48	48
1-1/2	40	48.3	57	57
2	50	60.3	64	64
2 1/2	65	73	76	76
3	80	88.9	86	86
3 1/2	90	101.6	95	95
4	100	114.3	105	105
5	125	141.3	124	124
6	150	168.3	143	143
8	200	219.1	178	178
10	250	273	216	216
12	300	323.8	254	254
14	350	355.6	279	279
16	400	406.4	305	305
18	450	457	343	343
20	500	508	381	381
22	550	559	419	419
24	600	610	432	432
26	650	660	495	495
28	700	711	521	521
30	750	762	559	559
32	800	813	597	597
34	850	864	635	635
36	900	914	673	673
38	950	965	711	711
40	1000	1016	749	749
42	1050	1067	762	711
44	1100	1118	813	762
46	1150	1168	851	800
48	1200	1219	889	838

(1) Outlet dimension M for NPS 26 and larger is recommended but not required.

# Butt Weld Fittings

## Dimensions

ASME B16.9, B16.28

### Reducing Tees and Concentric & Eccentric Reducers

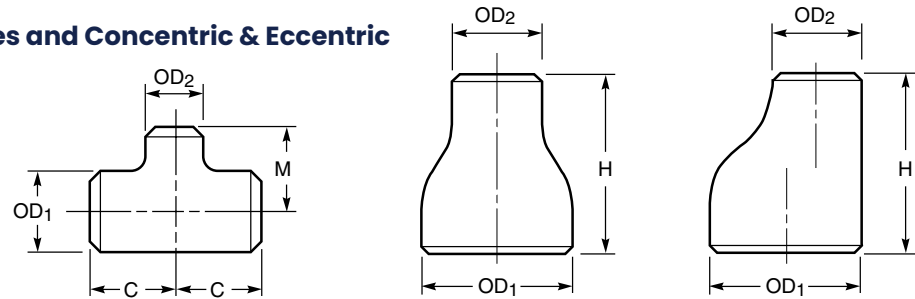

Nominal Pipe Size (NPS)		Outside Diameter at Bevel OD		Centre-to-End		End-to-End	Nominal Pipe Size (NPS)		Outside Diameter at Bevel OD		Centre-to-End		End-to-End
in	mm	OD1	OD2	C	M <sup>(1)</sup>	H	in	mm	OD1	OD2	C	M <sup>(1)</sup>	H
3/4 x 1/2	15 x 10	26.7	21.3	29	29	38	6 x 5	150 x 125	168.3	141.3	143	137	140
1 x 3/4	25 x 20	33.4	26.7	38	38	51	6 x 4	150 x 100	168.3	114.3	143	130	140
1 x 1/2	25 x 15	33.4	21.3	38	38	51	6 x 3-1/2	150 x 90	168.3	101.6	143	127	140
1-1/4 x 1	32 x 25	42.2	33.4	48	48	51	6 x 3	150 x 80	168.3	88.9	143	124	140
1-1/4 x 3/4	32 x 20	42.2	26.7	48	48	51	6 x 2-1/2	150 x 65	168.3	73.0	143	121	140
1-1/4 x 1/2	32 x 15	42.2	21.3	48	48	51	8 x 6	200 x 150	219.1	168.3	178	168	152
1-1/2 x 1-1/4	40 x 32	48.3	42.2	57	57	64	8 x 5	200 x 125	219.1	141.3	178	162	152
1-1/2 x 1	40 x 25	48.3	33.4	57	57	64	8 x 4	200 x 100	219.1	114.3	178	156	152
1-1/2 x 3/4	40 x 20	48.3	26.7	57	57	64	8 x 3-1/2	200 x 90	219.1	101.6	178	152	152
1-1/2 x 1/2	40 x 15	48.3	21.3	57	57	64	10 x 8	250 x 200	273.0	219.1	216	203	178
2 x 1-1/2	50 x 40	60.3	48.3	64	60	76	10 x 6	250 x 150	273.0	168.3	216	194	178
2 x 1-1/4	50 x 32	60.3	42.2	64	57	76	10 x 5	250 x 125	273.0	141.3	216	191	178
2 x 1	50 x 25	60.3	33.4	64	51	76	10 x 4	250 x 100	273.0	114.3	216	184	178
2 x 3/4	50 x 20	60.3	26.7	64	44	76	12 x 10	300 x 250	323.8	273.0	254	241	203
2-1/2 x 2	65 x 50	73.0	60.3	76	70	89	12 x 8	300 x 200	323.8	219.1	254	229	203
2-1/2 x 1-1/2	65 x 40	73.0	48.3	76	67	89	12 x 6	300 x 150	323.8	168.3	254	219	203
2-1/2 x 1-1/4	65 x 32	73.0	42.2	76	64	89	12 x 5	300 x 125	323.8	141.3	254	216	203
2-1/2 x 1	65 x 25	73.0	33.4	76	57	89	14 x 12	350 x 300	355.6	323.8	279	270	330
3 x 2-1/2	80 x 65	88.9	73.0	86	83	89	14 x 10	350 x 250	355.6	273.0	279	257	330
3 x 2	80 x 50	88.9	60.3	86	76	89	14 x 8	350 x 200	355.6	219.1	279	248	330
3 x 1-1/2	80 x 40	88.9	48.3	86	73	89	14 x 6	350 x 150	355.6	168.3	279	238	330
3 x 1-1/4	80 x 32	88.9	42.2	86	70	89	16 x 14	400 x 350	406.4	355.6	305	305	356
3 1/2 3	90 x 80	101.6	88.9	95	92	102	16 x 12	400 x 300	406.4	323.8	305	295	356
3-1/2 x 2-1/2	90 x 65	101.6	73.0	95	89	102	16 x 10	400 x 250	406.4	273.0	305	283	356
3-1/2 x 2	90 x 50	101.6	60.3	95	83	102	16 x 8	400 x 200	406.4	219.1	305	273	356
3-1/2 x 1-1/2	90 x 40	101.6	48.3	95	79	102	16 x 6	400 x 150	406.4	168.3	305	264	356
4 x 3-1/2	100 x 90	114.3	101.6	105	102	102	18 x 16	450 x 400	457	406.4	343	330	381
4 x 3	100 x 80	114.3	88.9	105	98	102	18 x 14	450 x 350	457	355.6	343	330	381
4 x 2-1/2	100 x 65	114.3	73.0	105	95	102	18 x 12	450 x 300	457	323.8	343	321	381
4 x 2	100 x 50	114.3	60.3	105	89	102	18 x 10	450 x 250	457	273.0	343	308	381
4 x 1-1/2	100 x 40	114.3	48.3	105	86	102	18 x 8	450 x 200	457	219.1	343	298	381
5 x 4	125 x 100	141.3	114.3	125	117	127	20 x 18	500 x 450	508	457	381	368	508
5 x 3-1/2	125 x 90	141.3	101.6	124	114	127	20 x 16	500 x 400	508	406.4	381	356	508
5 x 3	125 x 80	141.3	88.9	124	111	127	20 x 14	500 x 350	508	355.6	381	356	508
5 x 2-1/2	125 x 65	141.3	73.0	124	108	127	20 x 12	500 x 300	508	323.8	381	346	508
5 x 2	125 x 50	141.3	60.3	124	105	127	20 x 10	500 x 250	508	273	381	333	508

# Butt Weld Fittings

## Dimensions

ASME B16.9, B16.28

### Reducing Tees and Concentric & Eccentric Reducers

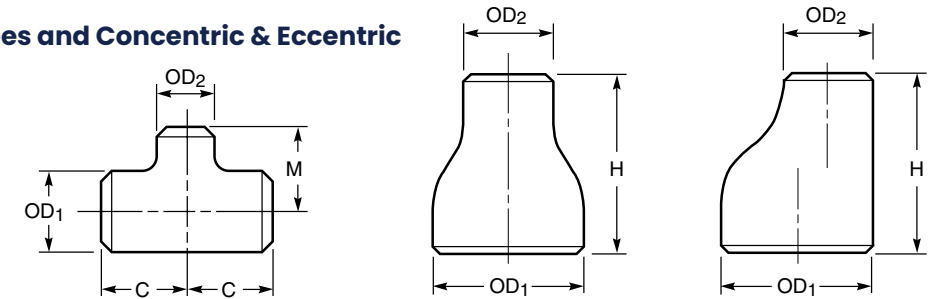

Nominal Pipe Size (NPS)		Outside Diameter at Bevel OD		Centre-to-End		End-to-End	Nominal Pipe Size (NPS)		Outside Diameter at Bevel OD		Centre-to-End		End-to-End
in	mm	OD1	OD2	C	M <sup>(1)</sup>	H	in	mm	OD1	OD2	C	M <sup>(1)</sup>	H
20 x 8	500 x 200	508	219.1	381	324	508	30 x 14	750 x 350	762	355.6	559	483	610
22 x 20	550 x 500	559	508	419	406	508	30 x 12	750 x 300	762	323.8	559	473	610
22 x 18	550 x 450	559	457	419	394	508	30 x 10	750 x 250	762	273.0	559	460	610
22 x 16	550 x 400	559	406.4	419	381	508	32 x 30	800 x 750	813	762	597	584	610
22 x 14	550 x 350	559	355.6	419	381	508	32 x 28	800 x 700	813	711	597	572	610
22 x 12	550 x 300	559	323.8	419	371	508	32 x 26	800 x 650	813	660	597	572	610
22 x 10	550 x 250	559	273.0	419	359	508	32 x 24	800 x 600	813	610	597	559	610
24 x 22	600 x 550	610	559	432	432	508	32 x 22	800 x 550	813	559	597	546	610
24 x 20	600 x 500	610	508	432	432	508	32 x 20	800 x 500	813	508	597	533	610
24 x 18	600 x 450	610	457	432	419	508	32 x 18	800 x 450	813	457	597	521	610
24 x 16	600 x 400	610	406.4	432	406	508	32 x 16	800 x 400	813	406.4	597	508	610
24 x 14	600 x 350	610	355.6	432	406	508	32 x 14	800 x 350	813	355.6	597	508	610
24 x 12	600 x 300	610	323.8	432	397	508	34 x 32	850 x 800	864	813	635	622	610
24 x 10	600 x 250	610	273.0	432	384	508	34 x 30	850 x 750	864	762	635	610	610
26 x 24	650 x 600	660	610	495	483	610	34 x 28	850 x 700	864	711	635	597	610
26 x 22	650 x 550	660	559	495	470	610	34 x 26	850 x 650	864	600	635	597	610
26 x 20	650 x 500	660	508	495	457	610	34 x 24	850 x 600	864	610	635	584	610
26 x 18	650 x 450	660	457	495	444	610	34 x 22	850 x 550	864	559	635	572	610
26 x 16	650 x 400	660	406.4	495	432	610	34 x 20	850 x 500	864	508	635	559	610
26 x 14	650 x 350	660	355.6	495	432	610	34 x 18	850 x 450	864	457	635	546	610
26 x 12	650 x 300	660	323.8	495	422	610	34 x 16	850 x 400	864	406.4	635	533	610
28 x 26	700 x 650	711	660	521	521	610	36 x 34	900 x 850	914	864	673	660	610
28 x 24	700 x 600	711	610	521	508	610	36 x 32	900 x 800	914	813	673	648	610
28 x 22	700 x 550	711	559	521	495	610	36 x 30	900 x 750	914	762	673	635	610
28 x 20	700 x 500	711	508	521	483	610	36 x 28	900 x 700	914	711	673	622	610
28 x 18	700 x 450	711	457	521	470	610	36 x 26	900 x 650	914	660	673	622	610
28 x 16	700 x 400	711	406.4	521	457	610	36 x 24	900 x 600	914	610	673	610	610
28 x 14	700 x 350	711	355.6	521	457	610	36 x 22	900 x 550	914	559	673	597	610
28 x 12	700 x 300	711	323.8	521	448	610	36 x 20	900 x 500	914	508	673	584	610
30 x 28	750 x 700	762	711	559	546	610	36 x 18	900 x 450	914	457	673	572	610
30 x 26	750 x 650	762	660	559	546	610	36 x 16	900 x 400	914	406.4	673	559	610
30 x 24	750 x 600	762	610	559	533	610	38 x 36	950 x 900	965	914	711	711	610
30 x 22	750 x 550	762	559	559	521	610	38 x 34	950 x 850	965	864	711	698	610
30 x 20	750 x 500	762	508	559	508	610	38 x 32	950 x 800	965	813	711	686	610
30 x 18	750 x 450	762	457	559	495	610	38 x 30	950 x 750	965	762	711	673	610
30 x 16	750 x 400	762	406.4	559	483	610	38 x 28	950 x 700	965	711	711	648	610

(1) Outlet dimension M for run sizes NPS 14 (DN 350) and larger is recommended but not required.

# Butt Weld Fittings

## Dimensions

ASME B16.9, B16.28

### Caps

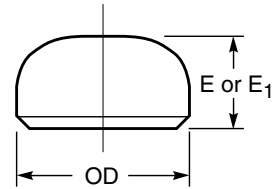

Nominal Pipe Size (NPS)		Outside Diameter at Bevel OD	End-to-End		
			Caps		
			Length <sup>(2)</sup>	Limiting Wall Thickness for Length "E"	Length <sup>(3)</sup>
in	mm	E	E1	E1	
1/2	15	21.3	25	4.57	25
3/4	20	26.7	25	3.81	25
1	25	33.4	38	4.57	38
1-1/4	32	42.2	38	4.83	38
1-1/2	40	48.3	38	5.08	38
2	50	60.3	38	5.59	44
2 1/2	65	73	38	7.11	51
3	80	88.9	51	7.62	64
3 1/2	90	101.6	64	8.13	76
4	100	114.3	64	8.64	76
5	125	141.3	76	9.65	89
6	150	168.3	89	10.92	102
8	200	219.1	102	12.70	127
10	250	273	127	12.70	152
12	300	323.8	152	12.70	178
14	350	355.6	165	12.70	191
16	400	406.4	178	12.70	203
18	450	457	203	12.70	229
20	500	508	229	12.70	254
22	550	559	254	12.70	254
24	600	610	267	12.70	305
26	650	660	267		
28	700	711	267		
30	750	762	267		
32	800	813	267		
34	850	864	267		
36	900	914	267		
38	950	965	305		
40	1000	1016	305		
42	1050	1067	305		
44	1100	1118	343		
46	1150	1168	343		
48	1200	1219	343		

(2) Length E applies for thickness not exceeding that given in column "Limiting Wall Thickness for Length E".

(3) Length E1 applies for thickness greater than that given in column "Limiting Wall Thickness for Length E" for NPS 24 and smaller.

# Butt Weld Fittings

## Long Radius Elbows 45° - Welded

**Grades:** 316L  
**Schedule:** 10S, 40S  
**Unit of Supply:** Each

**Certification:** Acc. to  
 ASME SA403 / ASTM A815 to ASME B16.9



### FPWE

Product Code	Grade	Schedule	Product Size (mm)	Description	Weight ea (kg)
FPWE020NBS1045LG316L	G316L	10S	020NB SCH10S (3/4")	ELBOW 45DEG LONG RADIUS G316L A403/A815	0.03
FPWE025NBS1045LG316L	G316L	10S	025NB SCH10S (1")	ELBOW 45DEG LONG RADIUS G316L A403/A815	0.09
FPWE032NBS1045LG316L	G316L	10S	032NB SCH10S (1-1/4")	ELBOW 45DEG LONG RADIUS G316L A403/A815	0.11
FPWE040NBS1045LG316L	G316L	10S	040NB SCH10S (1-1/2")	ELBOW 45DEG LONG RADIUS G316L A403/A815	0.17
FPWE050NBS1045LG316L	G316L	10S	050NB SCH10S (2")	ELBOW 45DEG LONG RADIUS G316L A403/A815	0.25
FPWE065NBS1045LG316L	G316L	10S	065NB SCH10S (2-1/2")	ELBOW 45DEG LONG RADIUS G316L A403/A815	0.48
FPWE080NBS1045LG316L	G316L	10S	080NB SCH10S (3")	ELBOW 45DEG LONG RADIUS G316L A403/A815	0.63
FPWE100NBS1045LG316L	G316L	10S	100NB SCH10S (4")	ELBOW 45DEG LONG RADIUS G316L A403/A815	1.08
FPWE125NBS1045LG316L	G316L	10S	125NB SCH10S (5")	ELBOW 45DEG LONG RADIUS G316L A403/A815	1.81
FPWE150NBS1045LG316L	G316L	10S	150NB SCH10S (6")	ELBOW 45DEG LONG RADIUS G316L A403/A815	2.72
FPWE200NBS1045LG316L	G316L	10S	200NB SCH10S (8")	ELBOW 45DEG LONG RADIUS G316L A403/A815	5.33
FPWE250NBS1045LG316L	G316L	10S	250NB SCH10S (10")	ELBOW 45DEG LONG RADIUS G316L A403/A815	9.75
FPWE300NBS1045LG316L	G316L	10S	300NB SCH10S (12")	ELBOW 45DEG LONG RADIUS G316L A403/A815	13.61
FPWE350NBS1045LG316L	G316L	10S	350NB SCH10S (14")	ELBOW 45DEG LONG RADIUS G316L A403/A815	18.14
FPWE400NBS1045LG316L	G316L	10S	400NB SCH10S (16")	ELBOW 45DEG LONG RADIUS G316L A403/A815	23.81
FPWE450NBS1045LG316L	G316L	10S	450NB SCH10S (18")	ELBOW 45DEG LONG RADIUS G316L A403/A815	28.70
FPWE500NBS1045LG316L	G316L	10S	500NB SCH10S (20")	ELBOW 45DEG LONG RADIUS G316L A403/A815	41.10
FPWE600NBS1045LG316L	G316L	10S	600NB SCH10S (24")	ELBOW 45DEG LONG RADIUS G316L A403/A815	68.00
FPWE020NBS4045LG316L	G316L	40S	020NB SCH40S (3/4")	ELBOW 45DEG LONG RADIUS G316L A403/A815	0.04
FPWE025NBS4045LG316L	G316L	40S	025NB SCH40S (1")	ELBOW 45DEG LONG RADIUS G316L A403/A815	0.11
FPWE032NBS4045LG316L	G316L	40S	032NB SCH40S (1-1/4")	ELBOW 45DEG LONG RADIUS G316L A403/A815	0.17
FPWE040NBS4045LG316L	G316L	40S	040NB SCH40S (1-1/2")	ELBOW 45DEG LONG RADIUS G316L A403/A815	0.23
FPWE050NBS4045LG316L	G316L	40S	050NB SCH40S (2")	ELBOW 45DEG LONG RADIUS G316L A403/A815	0.40
FPWE065NBS4045LG316L	G316L	40S	065NB SCH40S (2-1/2")	ELBOW 45DEG LONG RADIUS G316L A403/A815	0.77
FPWE080NBS4045LG316L	G316L	40S	080NB SCH40S (3")	ELBOW 45DEG LONG RADIUS G316L A403/A815	1.08
FPWE100NBS4045LG316L	G316L	40S	100NB SCH40S (4")	ELBOW 45DEG LONG RADIUS G316L A403/A815	2.09
FPWE150NBS4045LG316L	G316L	40S	150NB SCH40S (6")	ELBOW 45DEG LONG RADIUS G316L A403/A815	5.44
FPWE200NBS4045LG316L	G316L	40S	200NB SCH40S (8")	ELBOW 45DEG LONG RADIUS G316L A403/A815	10.77
FPWE250NBS4045LG316L	G316L	40S	250NB SCH40S (10")	ELBOW 45DEG LONG RADIUS G316L A403/A815	17.70
FPWE300NBS4090LG316L	G316L	40S	300NB SCH40S (12")	ELBOW 45DEG LONG RADIUS G316L A403/A815	28.10
FPWE350NBS4045LG316L	G316L	40S	350NB SCH40S (14")	ELBOW 45DEG LONG RADIUS G316L A403/A815	35.90
FPWE400NBS4045LG316L	G316L	40S	400NB SCH40S (16")	ELBOW 45DEG LONG RADIUS G316L A403/A815	47.20
FPWE450NBS4045LG316L	G316L	40S	450NB SCH40S (18")	ELBOW 45DEG LONG RADIUS G316L A403/A815	59.90
FPWE500NBS4045LG316L	G316L	40S	500NB SCH40S (20")	ELBOW 45DEG LONG RADIUS G316L A403/A815	73.60
FPWE600NBS4045LG316L	G316L	40S	600NB SCH40S (24")	ELBOW 45DEG LONG RADIUS G316L A403/A815	106.00

# Butt Weld Fittings

## Long Radius Elbows 90° - Welded

**Grades:** 304L, 316L, 2205  
**Schedule:** 10S, 40S  
**Unit of Supply:** Each

**Certification:** Acc. to  
 ASME SA403 / ASTM A815 to ASME B16.9



### FPWE

Product Code	Grade	Schedule	Product Size (mm)	Description	Weight ea (kg)
<b>G304L</b>					
FPWE015NBS1090LG304L	G304L	10S	015NB SCH10S (1/2")	ELBOW 90DEG LONG RADIUS G304L A403/A815	0.06
FPWE020NBS1090LG304L	G304L	10S	020NB SCH10S (3/4")	ELBOW 90DEG LONG RADIUS G304L A403/A815	0.07
FPWE025NBS1090LG304L	G304L	10S	025NB SCH10S (1")	ELBOW 90DEG LONG RADIUS G304L A403/A815	0.14
FPWE032NBS1090LG304L	G304L	10S	032NB SCH10S (1-1/4")	ELBOW 90DEG LONG RADIUS G304L A403/A815	0.23
FPWE040NBS1090LG304L	G304L	10S	040NB SCH10S (1-1/2")	ELBOW 90DEG LONG RADIUS G304L A403/A815	0.31
FPWE050NBS1090LG304L	G304L	10S	050NB SCH10S (2")	ELBOW 90DEG LONG RADIUS G304L A403/A815	0.54
FPWE065NBS1090LG304L	G304L	10S	065NB SCH10S (2-1/2")	ELBOW 90DEG LONG RADIUS G304L A403/A815	0.85
FPWE080NBS1090LG304L	G304L	10S	080NB SCH10S (3")	ELBOW 90DEG LONG RADIUS G304L A403/A815	1.22
FPWE100NBS1090LG304L	G304L	10S	100NB SCH10S (4")	ELBOW 90DEG LONG RADIUS G304L A403/A815	2.15
FPWE150NBS1090LG304L	G304L	10S	150NB SCH10S (6")	ELBOW 90DEG LONG RADIUS G304L A403/A815	4.90
FPWE200NBS1090LG304L	G304L	10S	200NB SCH10S (8")	ELBOW 90DEG LONG RADIUS G304L A403/A815	10.66
FPWE250NBS1090LG304L	G304L	10S	250NB SCH10S (10")	ELBOW 90DEG LONG RADIUS G304L A403/A815	19.50
FPWE300NBS1090LG304L	G304L	10S	300NB SCH10S (12")	ELBOW 90DEG LONG RADIUS G304L A403/A815	27.22
FPWE400NBS1090LG304L	G304L	10S	400NB SCH10S (16")	ELBOW 90DEG LONG RADIUS G304L A403/A815	47.63
FPWE015NBS4090LG304L	G304L	40S	015NB SCH40S (1/2")	ELBOW 90DEG LONG RADIUS G304L A403/A815	0.08
FPWE020NBS4090LG304L	G304L	40S	020NB SCH40S (3/4")	ELBOW 90DEG LONG RADIUS G304L A403/A815	0.09
FPWE025NBS4090LG304L	G304L	40S	025NB SCH40S (1")	ELBOW 90DEG LONG RADIUS G304L A403/A815	0.15
FPWE032NBS4090LG304L	G304L	40S	032NB SCH40S (1-1/4")	ELBOW 90DEG LONG RADIUS G304L A403/A815	0.25
FPWE040NBS4090LG304L	G304L	40S	040NB SCH40S (1-1/2")	ELBOW 90DEG LONG RADIUS G304L A403/A815	0.40
FPWE050NBS4090LG304L	G304L	40S	050NB SCH40S (2")	ELBOW 90DEG LONG RADIUS G304L A403/A815	0.71
FPWE065NBS4090LG304L	G304L	40S	065NB SCH40S (2-1/2")	ELBOW 90DEG LONG RADIUS G304L A403/A815	1.36
FPWE080NBS4090LG304L	G304L	40S	080NB SCH40S (3")	ELBOW 90DEG LONG RADIUS G304L A403/A815	2.18
FPWE100NBS4090LG304L	G304L	40S	100NB SCH40S (4")	ELBOW 90DEG LONG RADIUS G304L A403/A815	4.17
FPWE150NBS4090LG304L	G304L	40S	150NB SCH40S (6")	ELBOW 90DEG LONG RADIUS G304L A403/A815	10.89
FPWE200NBS4090LG304L	G304L	40S	200NB SCH40S (8")	ELBOW 90DEG LONG RADIUS G304L A403/A815	21.55
<b>G316L</b>					
FPWE015NBS1090LG316L	G316L	10S	015NB SCH10S (1/2")	ELBOW 90DEG LONG RADIUS G316L A403/A815	0.06
FPWE020NBS1090LG316L	G316L	10S	020NB SCH10S (3/4")	ELBOW 90DEG LONG RADIUS G316L A403/A815	0.07
FPWE025NBS1090LG316L	G316L	10S	025NB SCH10S (1")	ELBOW 90DEG LONG RADIUS G316L A403/A815	0.14
FPWE032NBS1090LG316L	G316L	10S	032NB SCH10S (1-1/4")	ELBOW 90DEG LONG RADIUS G316L A403/A815	0.23
FPWE040NBS1090LG316L	G316L	10S	040NB SCH10S (1-1/2")	ELBOW 90DEG LONG RADIUS G316L A403/A815	0.31
FPWE050NBS1090LG316L	G316L	10S	050NB SCH10S (2")	ELBOW 90DEG LONG RADIUS G316L A403/A815	0.51
FPWE065NBS1090LG316L	G316L	10S	065NB SCH10S (2-1/2")	ELBOW 90DEG LONG RADIUS G316L A403/A815	0.85
FPWE080NBS1090LG316L	G316L	10S	080NB SCH10S (3")	ELBOW 90DEG LONG RADIUS G316L A403/A815	1.22
FPWE090NBS1090LG316L	G316L	10S	090NB SCH10S (3-1/2")	ELBOW 90DEG LONG RADIUS G316L A403/A815	1.70
FPWE100NBS1090LG316L	G316L	10S	100NB SCH10S (4")	ELBOW 90DEG LONG RADIUS G316L A403/A815	2.15
FPWE125NBS1090LG316L	G316L	10S	125NB SCH10S (5")	ELBOW 90DEG LONG RADIUS G316L A403/A815	3.63
FPWE150NBS1090LG316L	G316L	10S	150NB SCH10S (6")	ELBOW 90DEG LONG RADIUS G316L A403/A815	4.90
FPWE200NBS1090LG316L	G316L	10S	200NB SCH10S (8")	ELBOW 90DEG LONG RADIUS G316L A403/A815	10.66
FPWE250NBS1090LG316L	G316L	10S	250NB SCH10S (10")	ELBOW 90DEG LONG RADIUS G316L A403/A815	19.50
FPWE300NBS1090LG316L	G316L	10S	300NB SCH10S (12")	ELBOW 90DEG LONG RADIUS G316L A403/A815	27.22

# Butt Weld Fittings

## Long Radius Elbows 90° - Welded

**Grades:** 304L, 316L, 2205  
**Schedule:** 10S, 40S  
**Unit of Supply:** Each

**Certification:** Acc. to  
 ASME SA403 / ASTM A815 to ASME B16.9



### FPWE

Product Code	Grade	Schedule	Product Size (mm)	Description	Weight ea (kg)
FPWE350NBS1090LG316L	G316L	10S	350NB SCH10S (14")	ELBOW 90DEG LONG RADIUS G316L A403/A815	36.30
FPWE400NBS1090LG316L	G316L	10S	400NB SCH10S (16")	ELBOW 90DEG LONG RADIUS G316L A403/A815	47.63
FPWE450NBS1090LG316L	G316L	10S	450NB SCH10S (18")	ELBOW 90DEG LONG RADIUS G316L A403/A815	59.87
FPWE500NBS1090LG316L	G316L	10S	500NB SCH10S (20")	ELBOW 90DEG LONG RADIUS G316L A403/A815	99.79
FPWE600NBS1090LG316L	G316L	10S	600NB SCH10S (24")	ELBOW 90DEG LONG RADIUS G316L A403/A815	140.61
FPWE750NBS1090LG316L	G316L	10S	750NB SCH10S (30")	ELBOW 90DEG LONG RADIUS G316L A403/A815	270.00
FPWE015NBS4090LG316L	G316L	40S	015NB SCH40S (1/2")	ELBOW 90DEG LONG RADIUS G316L A403/A815	0.08
FPWE020NBS4090LG316L	G316L	40S	020NB SCH40S (3/4")	ELBOW 90DEG LONG RADIUS G316L A403/A815	0.09
FPWE025NBS4090LG316L	G316L	40S	025NB SCH40S (1")	ELBOW 90DEG LONG RADIUS G316L A403/A815	0.16
FPWE032NBS4090LG316L	G316L	40S	032NB SCH40S (1-1/4")	ELBOW 90DEG LONG RADIUS G316L A403/A815	0.25
FPWE040NBS4090LG316L	G316L	40S	040NB SCH40S (1-1/2")	ELBOW 90DEG LONG RADIUS G316L A403/A815	0.40
FPWE050NBS4090LG316L	G316L	40S	050NB SCH40S (2")	ELBOW 90DEG LONG RADIUS G316L A403/A815	0.71
FPWE065NBS4090LG316L	G316L	40S	065NB SCH40S (2-1/2")	ELBOW 90DEG LONG RADIUS G316L A403/A815	1.36
FPWE080NBS4090LG316L	G316L	40S	080NB SCH40S (3")	ELBOW 90DEG LONG RADIUS G316L A403/A815	2.18
FPWE090NBS4090LG316L	G316L	40S	090NB SCH40S (3-1/2")	ELBOW 90DEG LONG RADIUS G316L A403/A815	1.83
FPWE100NBS4090LG316L	G316L	40S	100NB SCH40S (4")	ELBOW 90DEG LONG RADIUS G316L A403/A815	4.17
FPWE125NBS4090LG316L	G316L	40S	125NB SCH40S (5")	ELBOW 90DEG LONG RADIUS G316L A403/A815	6.86
FPWE150NBS4090LG316L	G316L	40S	150NB SCH40S (6")	ELBOW 90DEG LONG RADIUS G316L A403/A815	10.89
FPWE200NBS4090LG316L	G316L	40S	200NB SCH40S (8")	ELBOW 90DEG LONG RADIUS G316L A403/A815	21.55
FPWE250NBS4090LG316L	G316L	40S	250NB SCH40S (10")	ELBOW 90DEG LONG RADIUS G316L A403/A815	38.56
FPWE300NBS4090LG316L	G316L	40S	300NB SCH40S (12")	ELBOW 90DEG LONG RADIUS G316L A403/A815	59.42
FPWE350NBS4090LG316L	G316L	40S	350NB SCH40S (14")	ELBOW 90DEG LONG RADIUS G316L A403/A815	69.60
FPWE400NBS4090LG316L	G316L	40S	400NB SCH40S (16")	ELBOW 90DEG LONG RADIUS G316L A403/A815	91.60
FPWE450NBS4090LG316L	G316L	40S	450NB SCH40S (18")	ELBOW 90DEG LONG RADIUS G316L A403/A815	116.00
FPWE500NBS4090LG316L	G316L	40S	500NB SCH40S (20")	ELBOW 90DEG LONG RADIUS G316L A403/A815	143.00
FPWE600NBS4090LG316L	G316L	40S	600NB SCH40S (24")	ELBOW 90DEG LONG RADIUS G316L A403/A815	206.00
FPWE750NBS4090LG316L	G316L	40S	750NB SCH40S (30")	ELBOW 90DEG LONG RADIUS G316L A403/A815	324.00



# Butt Weld Fittings

## Long Radius Elbows 90° - Welded

**Grades:** 304L, 316L, 2205  
**Schedule:** 10S, 40S  
**Unit of Supply:** Each

**Certification:** Acc. to  
 ASME SA403 / ASTM A815 to ASME B16.9



### FPWE

Product Code	Grade	Schedule	Product Size (mm)	Description	Weight ea (kg)
<b>G2205</b>					
FPWE020NBS1090LG2205	G2205	10S	020NB SCH10SS (3/4")	ELBOW 90DEG LONG RADIUS G2205 A403/A815	0.07
FPWE025NBS1090LG2205	G2205	10S	025NB SCH10S (1")	ELBOW 90DEG LONG RADIUS G2205 A403/A815	0.14
FPWE032NBS1090LG2205	G2205	10S	032NB SCH10S (1-1/4")	ELBOW 90DEG LONG RADIUS G2205 A403/A815	0.23
FPWE040NBS1090LG2205	G2205	10S	040NB SCH10S (1-1/2")	ELBOW 90DEG LONG RADIUS G2205 A403/A815	0.31
FPWE050NBS1090LG2205	G2205	10S	050NB SCH10S (2")	ELBOW 90DEG LONG RADIUS G2205 A403/A815	0.51
FPWE065NBS1090LG2205	G2205	10S	065NB SCH10S (2-1/2")	ELBOW 90DEG LONG RADIUS G2205 A403/A815	0.85
FPWE080NBS1090LG2205	G2205	10S	080NB SCH10S (3")	ELBOW 90DEG LONG RADIUS G2205 A403/A815	1.22
FPWE100NBS1090LG2205	G2205	10S	100NB SCH10S (4")	ELBOW 90DEG LONG RADIUS G2205 A403/A815	2.15
FPWE125NBS1090LG2205	G2205	10S	125NB SCH10S (5")	ELBOW 90DEG LONG RADIUS G2205 A403/A815	3.63
FPWE150NBS1090LG2205	G2205	10S	150NB SCH10S (6")	ELBOW 90DEG LONG RADIUS G2205 A403/A815	4.90
FPWE015NBS4090LG2205	G2205	40S	015NB SCH40S (1/2")	ELBOW 90DEG LONG RADIUS G2205 A403/A815	0.08
FPWE020NBS4090LG2205	G2205	40S	020NB SCH40S (3/4")	ELBOW 90DEG LONG RADIUS G2205 A403/A815	0.09
FPWE025NBS4090LG2205	G2205	40S	025NB SCH40S (1")	ELBOW 90DEG LONG RADIUS G2205 A403/A815	0.16
FPWE040NBS4090LG2205	G2205	40S	040NB SCH40S (1-1/2")	ELBOW 90DEG LONG RADIUS G2205 A403/A815	0.40
FPWE050NBS4090LG2205	G2205	40S	050NB SCH40S (2")	ELBOW 90DEG LONG RADIUS G2205 A403/A815	0.71
FPWE065NBS4090LG2205	G2205	40S	065NB SCH40S (2-1/2")	ELBOW 90DEG LONG RADIUS G2205 A403/A815	1.36
FPWE080NBS4090LG2205	G2205	40S	080NB SCH40S (3")	ELBOW 90DEG LONG RADIUS G2205 A403/A815	2.18
FPWE100NBS4090LG2205	G2205	40S	100NB SCH40S (4")	ELBOW 90DEG LONG RADIUS G2205 A403/A815	4.17
FPWE150NBS4090LG2205	G2205	40S	150NB SCH40S (6")	ELBOW 90DEG LONG RADIUS G2205 A403/A815	10.89

# Butt Weld Fittings

## Long Radius Elbows 90° - Seamless

**Grades:** 316L  
**Schedule:** 10S, 40S, 80S  
**Unit of Supply:** Each

**Certification:** Acc. to  
 ASME SA403 / ASTM A815 to ASME B16.9



### FPSSSE

Product Code	Grade	Schedule	Product Size (mm)	Description	Weight ea (kg)
FPSSSE015NBS1090G316L	G316L	10S	15NB SCH10S (1/2")	ELBOW 90DEG LONG RADIUS 316L SEAMLESS A403/A815	0.06
FPSSSE020NBS1090G316L	G316L	10S	20NB SCH10S (3/4")	ELBOW 90DEG LONG RADIUS 316L SEAMLESS A403/A815	0.07
FPSSSE025NBS1090G316L	G316L	10S	25NB SCH10S (1")	ELBOW 90DEG LONG RADIUS 316L SEAMLESS A403/A815	0.14
FPSSSE032NBS1090G316L	G316L	10S	32NB SCH10S (1-1/4")	ELBOW 90DEG LONG RADIUS 316L SEAMLESS A403/A815	0.23
FPSSSE040NBS1090G316L	G316L	10S	40NB SCH10S (1-1/2")	ELBOW 90DEG LONG RADIUS 316L SEAMLESS A403/A815	0.31
FPSSSE050NBS1090G316L	G316L	10S	50NB SCH10S (2")	ELBOW 90DEG LONG RADIUS 316L SEAMLESS A403/A815	0.54
FPSSSE065NBS1090G316L	G316L	10S	65NB SCH10S (2-1/2")	ELBOW 90DEG LONG RADIUS 316L SEAMLESS A403/A815	0.65
FPSSSE080NBS1090G316L	G316L	10S	80NB SCH10S (3")	ELBOW 90DEG LONG RADIUS 316L SEAMLESS A403/A815	1.22
FPSSSE100NBS1090G316L	G316L	10S	100NB SCH10S (4")	ELBOW 90DEG LONG RADIUS 316L SEAMLESS A403/A815	2.15
FPSSSE015NBS4090G316L	G316L	40S	15NB SCH40S (1/2")	ELBOW 90DEG LONG RADIUS 316L SEAMLESS A403/A815	0.08
FPSSSE020NBS4090G316L	G316L	40S	20NB SCH40S (3/4")	ELBOW 90DEG LONG RADIUS 316L SEAMLESS A403/A815	0.09
FPSSSE025NBS4090G316L	G316L	40S	25NB SCH40S (1")	ELBOW 90DEG LONG RADIUS 316L SEAMLESS A403/A815	0.15
FPSSSE032NBS4090G316L	G316L	40S	32NB SCH40S (1-1/4")	ELBOW 90DEG LONG RADIUS 316L SEAMLESS A403/A815	0.25
FPSSSE040NBS4090G316L	G316L	40S	40NB SCH40S (1-1/2")	ELBOW 90DEG LONG RADIUS 316L SEAMLESS A403/A815	0.40
FPSSSE050NBS4090G316L	G316L	40S	50NB SCH40S (2")	ELBOW 90DEG LONG RADIUS 316L SEAMLESS A403/A815	0.71
FPSSSE065NBS4090G316L	G316L	40S	65NB SCH40S (2-1/2")	ELBOW 90DEG LONG RADIUS 316L SEAMLESS A403/A815	1.36
FPSSSE080NBS4090G316L	G316L	40S	80NB SCH40S (3")	ELBOW 90DEG LONG RADIUS 316L SEAMLESS A403/A815	2.18
FPSSSE100NBS4090G316L	G316L	40S	100NB SCH40S (4")	ELBOW 90DEG LONG RADIUS 316L SEAMLESS A403/A815	4.17
FPSSSE015NBS8090G316L	G316L	80S	015NB SCH80S (1/2")	ELBOW 90DEG LONG RADIUS 316L SEAMLESS A403/A815	0.10
FPSSSE020NBS8090G316L	G316L	80S	020NB SCH80S (3/4")	ELBOW 90DEG LONG RADIUS 316L SEAMLESS A403/A815	0.15
FPSSSE025NBS8090G316L	G316L	80S	025NB SCH80S (1")	ELBOW 90DEG LONG RADIUS 316L SEAMLESS A403/A815	0.22
FPSSSE040NBS8090G316L	G316L	80S	040NB SCH80S (1-1/2")	ELBOW 90DEG LONG RADIUS 316L SEAMLESS A403/A815	0.51
FPSSSE050NBS8090G316L	G316L	80S	050NB SCH80S (2")	ELBOW 90DEG LONG RADIUS 316L SEAMLESS A403/A815	0.91
FPSSSE080NBS8090G316L	G316L	80S	080NB SCH80S (3")	ELBOW 90DEG LONG RADIUS 316L SEAMLESS A403/A815	2.98

# Butt Weld Fittings

## Short Radius Elbows 90° – Welded

**Grades:** 316L  
**Schedule:** 10S, 40S  
**Unit of Supply:** Each

**Certification:** Acc. to  
 ASME SA403 / ASTM A815 to ASME B16.9



### FPWE

Product Code	Grade	Schedule	Product Size (mm)	Description	Weight ea (kg)
FPWE025NBS1090SG316L	G316L	10S	025NB SCH10S (1")	ELBOW 90DEG SHORT RADIUS G316L A403/A815	0.10
FPWE040NBS1090SG316L	G316L	10S	040NB SCH10S (1-1/2")	ELBOW 90DEG SHORT RADIUS G316L A403/A815	0.22
FPWE050NBS1090SG316L	G316L	10S	050NB SCH10S (2")	ELBOW 90DEG SHORT RADIUS G316L A403/A815	0.37
FPWE065NBS1090SG316L	G316L	10S	065NB SCH10S (2-1/2")	ELBOW 90DEG SHORT RADIUS G316L A403/A815	0.62
FPWE080NBS1090SG316L	G316L	10S	080NB SCH10S (3")	ELBOW 90DEG SHORT RADIUS G316L A403/A815	0.98
FPWE100NBS1090SG316L	G316L	10S	100NB SCH10S (4")	ELBOW 90DEG SHORT RADIUS G316L A403/A815	1.72
FPWE150NBS1090SG316L	G316L	10S	150NB SCH10S (6")	ELBOW 90DEG SHORT RADIUS G316L A403/A815	4.15
FPWE200NBS1090SG316L	G316L	10S	200NB SCH10S (8")	ELBOW 90DEG SHORT RADIUS G316L A403/A815	8.00
FPWE250NBS1090SG316L	G316L	10S	250NB SCH10S (10")	ELBOW 90DEG SHORT RADIUS G316L A403/A815	12.40
FPWE300NBS1090SG316L	G316L	10S	300NB SCH10S (12")	ELBOW 90DEG SHORT RADIUS G316L A403/A815	16.70
FPWE350NBS1090SG316L	G316L	10S	350NB SCH10S (14")	ELBOW 90DEG SHORT RADIUS G316L A403/A815	22.40
FPWE400NBS1090SG316L	G316L	10S	400NB SCH10S (16")	ELBOW 90DEG SHORT RADIUS G316L A403/A815	29.30
FPWE450NBS1090SG316L	G316L	10S	450NB SCH10S (18")	ELBOW 90DEG SHORT RADIUS G316L A403/A815	37.10
FPWE500NBS1090SG316L	G316L	10S	500NB SCH10S (20")	ELBOW 90DEG SHORT RADIUS G316L A403/A815	53.10
FPWE600NBS1090SG316L	G316L	10S	600NB SCH10S (24")	ELBOW 90DEG SHORT RADIUS G316L A403/A815	88.00
FPWE750NBS1090SG316L	G316L	10S	750NB SCH10S (30")	ELBOW 90DEG SHORT RADIUS G316L A403/A815	180.00
FPWE025NBS4090SG316L	G316L	40S	025NB SCH40S (1")	ELBOW 90DEG SHORT RADIUS G316L A403/A815	0.12
FPWE032NBS4090SG316L	G316L	40S	032NB SCH40S (1-1/4")	ELBOW 90DEG SHORT RADIUS G316L A403/A815	0.20
FPWE040NBS4090SG316L	G316L	40S	040NB SCH40S (1-1/2")	ELBOW 90DEG SHORT RADIUS G316L A403/A815	0.29
FPWE050NBS4090SG316L	G316L	40S	050NB SCH40S (2")	ELBOW 90DEG SHORT RADIUS G316L A403/A815	0.51
FPWE065NBS4090SG316L	G316L	40S	065NB SCH40S (2-1/2")	ELBOW 90DEG SHORT RADIUS G316L A403/A815	1.02
FPWE080NBS4090SG316L	G316L	40S	080NB SCH40S (3")	ELBOW 90DEG SHORT RADIUS G316L A403/A815	1.50
FPWE100NBS4090SG316L	G316L	40S	100NB SCH40S (4")	ELBOW 90DEG SHORT RADIUS G316L A403/A815	4.00
FPWE150NBS4090SG316L	G316L	40S	150NB SCH40S (6")	ELBOW 90DEG SHORT RADIUS G316L A403/A815	6.60

# Butt Weld Fittings

## Equal Tees – Welded

**Grades:** 316L  
**Schedule:** 10S, 40S, 80S  
**Unit of Supply:** Each

**Certification:** Acc. to  
 ASME SA403 / ASTM A815  
 to ASME B16.9



### FPWTE

Product Code	Grade	Schedule	Product Size (mm)	Description	Weight ea (kg)
FPWTE015NBS10G316L	G316L	10S	015NB SCH10S (1/2")	BUTT WELD EQUAL TEE G316L A403/A815	0.07
FPWTE020NBS10G316L	G316L	10S	020NB SCH10S (3/4")	BUTT WELD EQUAL TEE G316L A403/A815	0.09
FPWTE025NBS10G316L	G316L	10S	025NB SCH10S (1")	BUTT WELD EQUAL TEE G316L A403/A815	0.20
FPWTE032NBS10G316L	G316L	10S	032NB SCH10S (1-1/4")	BUTT WELD EQUAL TEE G316L A403/A815	0.33
FPWTE040NBS10G316L	G316L	10S	040NB SCH10S (1-1/2")	BUTT WELD EQUAL TEE G316L A403/A815	0.46
FPWTE050NBS10G316L	G316L	10S	050NB SCH10S (2")	BUTT WELD EQUAL TEE G316L A403/A815	0.63
FPWTE065NBS10G316L	G316L	10S	065NB SCH10S (2-1/2")	BUTT WELD EQUAL TEE G316L A403/A815	1.10
FPWTE080NBS10G316L	G316L	10S	080NB SCH10S (3")	BUTT WELD EQUAL TEE G316L A403/A815	1.37
FPWTE100NBS10G316L	G316L	10S	100NB SCH10S (4")	BUTT WELD EQUAL TEE G316L A403/A815	2.15
FPWTE125NBS10G316L	G316L	10S	125NB SCH10S (5")	BUTT WELD EQUAL TEE G316L A403/A815	3.48
FPWTE150NBS10G316L	G316L	10S	150NB SCH10S (6")	BUTT WELD EQUAL TEE G316L A403/A815	4.76
FPWTE200NBS10G316L	G316L	10S	200NB SCH10S (8")	BUTT WELD EQUAL TEE G316L A403/A815	8.46
FPWTE250NBS10G316L	G316L	10S	250NB SCH10S (10")	BUTT WELD EQUAL TEE G316L A403/A815	14.20
FPWTE300NBS10G316L	G316L	10S	300NB SCH10S (12")	BUTT WELD EQUAL TEE G316L A403/A815	21.60
FPWTE350NBS10G316L	G316L	10S	350NB SCH10S (14")	BUTT WELD EQUAL TEE G316L A403/A815	48.53
FPWTE400NBS10G316L	G316L	10S	400NB SCH10S (16")	BUTT WELD EQUAL TEE G316L A403/A815	58.97
FPWTE450NBS10G316L	G316L	10S	450NB SCH10S (18")	BUTT WELD EQUAL TEE G316L A403/A815	76.66
FPWTE500NBS10G316L	G316L	10S	500NB SCH10S (20")	BUTT WELD EQUAL TEE G316L A403/A815	103.42
FPWTE600NBS10G316L	G316L	10S	600NB SCH10S (24")	BUTT WELD EQUAL TEE G316L A403/A815	155.58
FPWTE750NBS10G316L	G316L	10S	750NB SCH10S (30")	BUTT WELD EQUAL TEE G316L A403/A815	437.99
FPWTE015NBS40G316L	G316L	40S	015NB SCH40S (1/2")	BUTT WELD EQUAL TEE G316L A403/A815	0.09
FPWTE020NBS40G316L	G316L	40S	020NB SCH40S (3/4")	BUTT WELD EQUAL TEE G316L A403/A815	0.12
FPWTE025NBS40G316L	G316L	40S	025NB SCH40S (1")	BUTT WELD EQUAL TEE G316L A403/A815	0.25
FPWTE032NBS40G316L	G316L	40S	032NB SCH40S (1-1/4")	BUTT WELD EQUAL TEE G316L A403/A815	0.42
FPWTE040NBS40G316L	G316L	40S	040NB SCH40S (1-1/2")	BUTT WELD EQUAL TEE G316L A403/A815	0.59
FPWTE050NBS40G316L	G316L	40S	050NB SCH40S (2")	BUTT WELD EQUAL TEE G316L A403/A815	0.87
FPWTE065NBS40G316L	G316L	40S	065NB SCH40S (2-1/2")	BUTT WELD EQUAL TEE G316L A403/A815	1.70
FPWTE080NBS40G316L	G316L	40S	080NB SCH40S (3")	BUTT WELD EQUAL TEE G316L A403/A815	1.90
FPWTE100NBS40G316L	G316L	40S	100NB SCH40S (4")	BUTT WELD EQUAL TEE G316L A403/A815	4.13
FPWTE150NBS40G316L	G316L	40S	150NB SCH40S (6")	BUTT WELD EQUAL TEE G316L A403/A815	9.73
FPWTE200NBS40G316L	G316L	40S	200NB SCH40S (8")	BUTT WELD EQUAL TEE G316L A403/A815	18.00
FPWTE250NBS40G316L	G316L	40S	250NB SCH40S (10")	BUTT WELD EQUAL TEE G316L A403/A815	30.80
FPWTE300NBS40G316L	G316L	40S	300NB SCH40S (12")	BUTT WELD EQUAL TEE G316L A403/A815	44.30
FPWTE350NBS40G316L	G316L	40S	350NB SCH40S (14")	BUTT WELD EQUAL TEE G316L A403/A815	74.90
FPWTE400NBS40G316L	G316L	40S	400NB SCH40S (16")	BUTT WELD EQUAL TEE G316L A403/A815	88.50
FPWTE450NBS40G316L	G316L	40S	450NB SCH40S (18")	BUTT WELD EQUAL TEE G316L A403/A815	113.00
FPWTE500NBS40G316L	G316L	40S	500NB SCH40S (20")	BUTT WELD EQUAL TEE G316L A403/A815	155.00
FPWTE600NBS40G316L	G316L	40S	600NB SCH40S (24")	BUTT WELD EQUAL TEE G316L A403/A815	240.00
FPWTE750NBS40G316L	G316L	40S	750NB SCH40S (30")	BUTT WELD EQUAL TEE G316L A403/A815	338.50

# Butt Weld Fittings

## Equal Tees - Seamless

**Grades:** 316L  
**Schedule:** 10S, 40S, 80S  
**Unit of Supply:** Each

**Certification:** Acc. to  
 ASME SA403 / ASTM A815  
 to ASME B16.9



### FPSSTE

Product Code	Grade	Schedule	Product Size (mm)	Description	Weight ea (kg)
FPSSTE015NBS10G316L	G316L	10S	15NB SCH10S (1/2")	EQUAL TEES 316L SEAMLESS A403/A815	0.07
FPSSTE020NBS10G316L	G316L	10S	20NB SCH10S (3/4")	EQUAL TEES 316L SEAMLESS A403/A815	0.09
FPSSTE025NBS10G316L	G316L	10S	25NB SCH10S (1")	EQUAL TEES 316L SEAMLESS A403/A815	0.20
FPSSTE032NBS10G316L	G316L	10S	32NB SCH10S (1-1/4")	EQUAL TEES 316L SEAMLESS A403/A815	0.33
FPSSTE040NBS10G316L	G316L	10S	40NB SCH10S (1-1/2")	EQUAL TEES 316L SEAMLESS A403/A815	0.46
FPSSTE050NBS10G316L	G316L	10S	50NB SCH10S (2")	EQUAL TEES 316L SEAMLESS A403/A815	0.63
FPSSTE065NBS10G316L	G316L	10S	65NB SCH10S (2-1/2")	EQUAL TEES 316L SEAMLESS A403/A815	1.10
FPSSTE080NBS10G316L	G316L	10S	80NB SCH10S (3")	EQUAL TEES 316L SEAMLESS A403/A815	1.37
FPSSTE100NBS10G316L	G316L	10S	100NB SCH10S (4")	EQUAL TEES 316L SEAMLESS A403/A815	2.15
FPSSTE015NBS40G316L	G316L	40S	15NB SCH40S (1/2")	EQUAL TEES 316L SEAMLESS A403/A815	0.09
FPSSTE020NBS40G316L	G316L	40S	20NB SCH40S (3/4")	EQUAL TEES 316L SEAMLESS A403/A815	0.12
FPSSTE025NBS40G316L	G316L	40S	25NB SCH40S (1")	EQUAL TEES 316L SEAMLESS A403/A815	0.25
FPSSTE032NBS40G316L	G316L	40S	32NB SCH40S (1-1/4")	EQUAL TEES 316L SEAMLESS A403/A815	0.42
FPSSTE040NBS40G316L	G316L	40S	40NB SCH40S (1-1/2")	EQUAL TEES 316L SEAMLESS A403/A815	0.59
FPSSTE050NBS40G316L	G316L	40S	50NB SCH40S (2")	EQUAL TEES 316L SEAMLESS A403/A815	0.87
FPSSTE065NBS40G316L	G316L	40S	65NB SCH40S (2-1/2")	EQUAL TEES 316L SEAMLESS A403/A815	1.70
FPSSTE080NBS40G316L	G316L	40S	80NB SCH40S (3")	EQUAL TEES 316L SEAMLESS A403/A815	1.90
FPSSTE100NBS40G316L	G316L	40S	100NB SCH40S (4")	EQUAL TEES 316L SEAMLESS A403/A815	4.13

# Butt Weld Fittings

## Reducing Tees - Welded

**Grades:** 316L  
**Schedule:** 10S, 40S  
**Unit of Supply:** Each

**Certification:** Acc. to  
 ASME SA403 / ASTM A815  
 to ASME B16.9



### FPWTR

Product Code	Grade	Schedule	Product Size (mm)	Description	Weight ea (kg)
FPWTR025015NBS10G316L	G316L	10S	025NB x 015NB SCH10S (1" x 1/2")	BUTT WELD REDUCING TEE G316L A403/A815	0.19
FPWTR025020NBS10G316L	G316L	10S	025NB x 020NB SCH10S (1" x 3/4")	BUTT WELD REDUCING TEE G316L A403/A815	0.23
FPWTR040015NBS10G316L	G316L	10S	040NB x 015NB SCH10S (1-1/2" x 1/2")	BUTT WELD REDUCING TEE G316L A403/A815	0.39
FPWTR040020NBS10G316L	G316L	10S	040NB x 020NB SCH10S (1-1/2" x 3/4")	BUTT WELD REDUCING TEE G316L A403/A815	0.39
FPWTR040025NBS10G316L	G316L	10S	040NB x 025NB SCH10S (1-1/2" x 1")	BUTT WELD REDUCING TEE G316L A403/A815	0.39
FPWTR050025NBS10G316L	G316L	10S	050NB x 025NB SCH10S (2" x 1")	BUTT WELD REDUCING TEE G316L A403/A815	0.59
FPWTR050040NBS10G316L	G316L	10S	050NB x 040NB SCH10S (2" x 1-1/2")	BUTT WELD REDUCING TEE G316L A403/A815	0.59
FPWTR065040NBS10G316L	G316L	10S	065NB x 040NB SCH10S (2-1/2" x 1-1/2")	BUTT WELD REDUCING TEE G316L A403/A815	0.90
FPWTR065050NBS10G316L	G316L	10S	065NB x 050NB SCH10S (2-1/2" x 2")	BUTT WELD REDUCING TEE G316L A403/A815	0.94
FPWTR080025NBS10G316L	G316L	10S	080NB x 025NB SCH10S (3" x 1")	BUTT WELD REDUCING TEE G316L A403/A815	1.23
FPWTR080040NBS10G316L	G316L	10S	080NB x 040NB SCH10S (3" x 1-1/2")	BUTT WELD REDUCING TEE G316L A403/A815	1.15
FPWTR080050NBS10G316L	G316L	10S	080NB x 050NB SCH10S (3" x 2")	BUTT WELD REDUCING TEE G316L A403/A815	2.16
FPWTR080065NBS10G316L	G316L	10S	080NB x 065NB SCH10S (3" x 2-1/2")	BUTT WELD REDUCING TEE G316L A403/A815	1.19
FPWTR100040NBS10G316L	G316L	10S	100NB x 040NB SCH10S (4" x 1-1/2")	BUTT WELD REDUCING TEE G316L A403/A815	2.45
FPWTR100050NBS10G316L	G316L	10S	100NB x 050NB SCH10S (4" x 2")	BUTT WELD REDUCING TEE G316L A403/A815	2.50
FPWTR100065NBS10G316L	G316L	10S	100NB x 065NB SCH10S (4" x 2-1/2")	BUTT WELD REDUCING TEE G316L A403/A815	2.50
FPWTR100080NBS10G316L	G316L	10S	100NB x 080NB SCH10S (4" x 3")	BUTT WELD REDUCING TEE G316L A403/A815	2.50
FPWTR150080NBS10G316L	G316L	10S	150NB x 080NB SCH10S (6" x 3")	BUTT WELD REDUCING TEE G316L A403/A815	4.90
FPWTR150100NBS10G316L	G316L	10S	150NB x 100NB SCH10S (6" x 4")	BUTT WELD REDUCING TEE G316L A403/A815	5.10
FPWTR200100NBS10G316L	G316L	10S	200NB x 100NB SCH10S (8" x 4")	BUTT WELD REDUCING TEE G316L A403/A815	8.00
FPWTR200150NBS10G316L	G316L	10S	200NB x 150NB SCH10S (8" x 6")	BUTT WELD REDUCING TEE G316L A403/A815	18.10
FPWTR250150NBS10G316L	G316L	10S	250NB x 150NB SCH10S (10" x 6")	BUTT WELD REDUCING TEE G316L A403/A815	14.00
FPWTR250200NBS10G316L	G316L	10S	250NB x 200NB SCH10S (10" x 8")	BUTT WELD REDUCING TEE G316L A403/A815	14.50
FPWTR300150NBS10G316L	G316L	10S	300NB x 150NB SCH10S (12" x 6")	BUTT WELD REDUCING TEE G316L A403/A815	29.00
FPWTR300200NBS10G316L	G316L	10S	300NB x 200NB SCH10S (12" x 8")	BUTT WELD REDUCING TEE G316L A403/A815	29.00
FPWTR300250NBS10G316L	G316L	10S	300NB x 250NB SCH10S (12" x 10")	BUTT WELD REDUCING TEE G316L A403/A815	29.00
FPWTR400200NBS10G316L	G316L	10S	400NB x 200NB SCH10S (16" x 8")	BUTT WELD REDUCING TEE G316L A403/A815	45.00
FPWTR400250NBS10G316L	G316L	10S	400NB x 250NB SCH10S (16" x 10")	BUTT WELD REDUCING TEE G316L A403/A815	46.00
FPWTR400300NBS10G316L	G316L	10S	400NB x 300NB SCH10S (16" x 12")	BUTT WELD REDUCING TEE G316L A403/A815	47.00
FPWTR400350NBS10G316L	G316L	10S	400NB x 350NB SCH10S (16" x 14")	BUTT WELD REDUCING TEE G316L A403/A815	48.00
FPWTR450300NBS10G316L	G316L	10S	450NB x 350NB SCH10S (18" x 14")	BUTT WELD REDUCING TEE G316L A403/A815	59.00
FPWTR450400NBS10G316L	G316L	10S	450NB x 400NB SCH10S (18" x 16")	BUTT WELD REDUCING TEE G316L A403/A815	60.00
FPWTR500250NBS10G316L	G316L	10S	500NB x 250NB SCH10S (20" x 10")	BUTT WELD REDUCING TEE G316L A403/A815	98.00
FPWTR500300NBS10G316L	G316L	10S	500NB x 300NB SCH10S (20" x 12")	BUTT WELD REDUCING TEE G316L A403/A815	98.00
FPWTR500350NBS10G316L	G316L	10S	500NB x 350NB SCH10S (20" x 14")	BUTT WELD REDUCING TEE G316L A403/A815	98.00
FPWTR500400NBS10G316L	G316L	10S	500NB x 400NB SCH10S (20" x 16")	BUTT WELD REDUCING TEE G316L A403/A815	98.00
FPWTR600400NBS10G316L	G316L	10S	600NB x 400NB SCH10S (24" x 16")	BUTT WELD REDUCING TEE G316L A403/A815	171.00
FPWTR600450NBS10G316L	G316L	10S	600NB x 450NB SCH10S (24" x 18")	BUTT WELD REDUCING TEE G316L A403/A815	172.00
FPWTR600500NBS10G316L	G316L	10S	600NB x 500NB SCH10S (24" x 20")	BUTT WELD REDUCING TEE G316L A403/A815	173.00
FPWTR750400NBS10G316L	G316L	10S	750NB x 400NB SCH10S (30" x 16")	BUTT WELD REDUCING TEE G316L A403/A815	415.00
FPWTR750500NBS10G316L	G316L	10S	750NB x 500NB SCH10S (30" x 20")	BUTT WELD REDUCING TEE G316L A403/A815	428.00
FPWTR750600NBS10G316L	G316L	10S	750NB x 600NB SCH10S (30" x 24")	BUTT WELD REDUCING TEE G316L A403/A815	429.00



# Butt Weld Fittings

## Reducing Tees - Welded

**Grades:** 316L  
**Schedule:** 10S, 40S  
**Unit of Supply:** Each

**Certification:** Acc. to  
 ASME SA403 / ASTM A815  
 to ASME B16.9



### FPWTR

Product Code	Grade	Schedule	Product Size (mm)	Description	Weight ea (kg)
FPWTR025020NBS40G316L	G316L	40S	025NB x 020NB SCH40S (1" x 3/4")	BUTT WELD REDUCING TEE G316L A403/A815	0.23
FPWTR040020NBS40G316L	G316L	40S	040NB x 020NB SCH40S (1-1/2" x 3/4")	BUTT WELD REDUCING TEE G316L A403/A815	0.52
FPWTR040025NBS40G316L	G316L	40S	040NB x 025NB SCH40S (1-1/2" x 1")	BUTT WELD REDUCING TEE G316L A403/A815	0.52
FPWTR050025NBS40G316L	G316L	40S	050NB x 025NB SCH40S (2" x 1")	BUTT WELD REDUCING TEE G316L A403/A815	0.74
FPWTR050040NBS40G316L	G316L	40S	050NB x 040NB SCH40S (2" x 1-1/2")	BUTT WELD REDUCING TEE G316L A403/A815	0.74
FPWTR065040NBS40G316L	G316L	40S	065NB x 040NB SCH40S (2-1/2" x 1-1/2")	BUTT WELD REDUCING TEE G316L A403/A815	1.49
FPWTR065050NBS40G316L	G316L	40S	065NB x 050NB SCH40S (2-1/2" x 2")	BUTT WELD REDUCING TEE G316L A403/A815	1.49
FPWTR080025NBS40G316L	G316L	40S	080NB x 025NB SCH40S (3" x 1")	BUTT WELD REDUCING TEE G316L A403/A815	2.16
FPWTR080040NBS40G316L	G316L	40S	080NB x 040NB SCH40S (3" x 1-1/2")	BUTT WELD REDUCING TEE G316L A403/A815	2.16
FPWTR080050NBS40G316L	G316L	40S	080NB x 050NB SCH40S (3" x 2")	BUTT WELD REDUCING TEE G316L A403/A815	2.29
FPWTR080065NBS40G316L	G316L	40S	080NB x 065NB SCH40S (3" x 2-1/2")	BUTT WELD REDUCING TEE G316L A403/A815	2.16
FPWTR100050NBS40G316L	G316L	40S	100NB x 050NB SCH40S (4" x 2")	BUTT WELD REDUCING TEE G316L A403/A815	4.50
FPWTR100065NBS40G316L	G316L	40S	100NB x 065NB SCH40S (4" x 2-1/2")	BUTT WELD REDUCING TEE G316L A403/A815	4.50
FPWTR100080NBS40G316L	G316L	40S	100NB x 080NB SCH40S (4" x 3")	BUTT WELD REDUCING TEE G316L A403/A815	4.50
FPWTR150080NBS40G316L	G316L	40S	150NB x 080NB SCH40S (6" x 3")	BUTT WELD REDUCING TEE G316L A403/A815	9.80
FPWTR150100NBS40G316L	G316L	40S	150NB x 100NB SCH40S (6" x 4")	BUTT WELD REDUCING TEE G316L A403/A815	9.80

# Butt Weld Fittings

## Concentric Reducers - Welded

**Grades:** 316L  
**Schedule:** 10S, 40S  
**Unit of Supply:** Each

**Certification:** Acc. to  
 ASME SA403 / ASTM A815  
 to ASME B16.9



### FPWRC

Product Code	Grade	Schedule	Product Size (mm)	Description	Weight ea (kg)
FPWRC020015NBS10G316L	G316L	10S	020NB x 015NB SCH10S (3/4" x 1/2")	CONCENTRIC REDUCER G316L A403/A815	0.10
FPWRC025015NBS10G316L	G316L	10S	025NB x 015NB SCH10S (1" x 1/2")	CONCENTRIC REDUCER G316L A403/A815	0.13
FPWRC025020NBS10G316L	G316L	10S	025NB x 020NB SCH10S (1" x 3/4")	CONCENTRIC REDUCER G316L A403/A815	0.13
FPWRC032020NBS10G316L	G316L	10S	032NB x 020NB SCH10S (1-1/4" x 3/4")	CONCENTRIC REDUCER G316L A403/A815	0.18
FPWRC032025NBS10G316L	G316L	10S	032NB x 025NB SCH10S (1-1/4" x 1")	CONCENTRIC REDUCER G316L A403/A815	0.18
FPWRC040015NBS10G316L	G316L	10S	040NB x 015NB SCH10S (1-1/2" x 1/2")	CONCENTRIC REDUCER G316L A403/A815	0.20
FPWRC040020NBS10G316L	G316L	10S	040NB x 020NB SCH10S (1-1/2" x 3/4")	CONCENTRIC REDUCER G316L A403/A815	0.20
FPWRC040025NBS10G316L	G316L	10S	040NB x 025NB SCH10S (1-1/2" x 1")	CONCENTRIC REDUCER G316L A403/A815	0.20
FPWRC040032NBS10G316L	G316L	10S	040NB x 032NB SCH10S (1-1/2" x 1-1/4")	CONCENTRIC REDUCER G316L A403/A815	0.20
FPWRC050020NBS10G316L	G316L	10S	050NB x 020NB SCH10S (2" x 3/4")	CONCENTRIC REDUCER G316L A403/A815	0.25
FPWRC050025NBS10G316L	G316L	10S	050NB x 025NB SCH10S (2" x 1")	CONCENTRIC REDUCER G316L A403/A815	0.25
FPWRC050032NBS10G316L	G316L	10S	050NB x 032NB SCH10S (2" x 1-1/4")	CONCENTRIC REDUCER G316L A403/A815	0.30
FPWRC050040NBS10G316L	G316L	10S	050NB x 040NB SCH10S (2" x 1-1/2")	CONCENTRIC REDUCER G316L A403/A815	0.25
FPWRC065040NBS10G316L	G316L	10S	065NB x 040NB SCH10S (2-1/2" x 1-1/2")	CONCENTRIC REDUCER G316L A403/A815	0.44
FPWRC065050NBS10G316L	G316L	10S	065NB x 050NB SCH10S (2-1/2" x 2")	CONCENTRIC REDUCER G316L A403/A815	0.44
FPWRC080025NBS10G316L	G316L	10S	080NB x 025NB SCH10S (3" x 1")	CONCENTRIC REDUCER G316L A403/A815	0.51
FPWRC080040NBS10G316L	G316L	10S	080NB x 040NB SCH10S (3" x 1-1/2")	CONCENTRIC REDUCER G316L A403/A815	0.49
FPWRC080050NBS10G316L	G316L	10S	080NB x 050NB SCH10S (3" x 2")	CONCENTRIC REDUCER G316L A403/A815	0.51
FPWRC080065NBS10G316L	G316L	10S	080NB x 065NB SCH10S (3" x 2-1/2")	CONCENTRIC REDUCER G316L A403/A815	0.51
FPWRC100050NBS10G316L	G316L	10S	100NB x 050NB SCH10S (4" x 2")	CONCENTRIC REDUCER G316L A403/A815	0.78
FPWRC100065NBS10G316L	G316L	10S	100NB x 065NB SCH10S (4" x 2-1/2")	CONCENTRIC REDUCER G316L A403/A815	0.78
FPWRC100080NBS10G316L	G316L	10S	100NB x 080NB SCH10S (4" x 3")	CONCENTRIC REDUCER G316L A403/A815	0.78
FPWRC125080NBS10G316L	G316L	10S	125NB x 080NB SCH10S (5" x 3")	CONCENTRIC REDUCER G316L A403/A815	1.45
FPWRC125100NBS10G316L	G316L	10S	125NB x 100NB SCH10S (5" x 4")	CONCENTRIC REDUCER G316L A403/A815	1.49
FPWRC150080NBS10G316L	G316L	10S	150NB x 080NB SCH10S (6" x 3")	CONCENTRIC REDUCER G316L A403/A815	1.82
FPWRC150100NBS10G316L	G316L	10S	150NB x 100NB SCH10S (6" x 4")	CONCENTRIC REDUCER G316L A403/A815	1.95
FPWRC150125NBS10G316L	G316L	10S	150NB x 125NB SCH10S (6" x 5")	CONCENTRIC REDUCER G316L A403/A815	1.95
FPWRC200100NBS10G316L	G316L	10S	200NB x 100NB SCH10S (8" x 4")	CONCENTRIC REDUCER G316L A403/A815	3.02
FPWRC200125NBS10G316L	G316L	10S	200NB x 125NB SCH10S (8" x 5")	CONCENTRIC REDUCER G316L A403/A815	3.08
FPWRC200150NBS10G316L	G316L	10S	200NB x 150NB SCH10S (8" x 6")	CONCENTRIC REDUCER G316L A403/A815	3.19
FPWRC250100NBS10G316L	G316L	10S	250NB x 100NB SCH10S (10" x 4")	CONCENTRIC REDUCER G316L A403/A815	4.50
FPWRC250125NBS10G316L	G316L	10S	250NB x 125NB SCH10S (10" x 5")	CONCENTRIC REDUCER G316L A403/A815	4.50
FPWRC250150NBS10G316L	G316L	10S	250NB x 150NB SCH10S (10" x 6")	CONCENTRIC REDUCER G316L A403/A815	5.00
FPWRC250200NBS10G316L	G316L	10S	250NB x 200NB SCH10S (10" x 8")	CONCENTRIC REDUCER G316L A403/A815	5.00
FPWRC300125NBS10G316L	G316L	10S	300NB x 125NB SCH10S (12" x 5")	CONCENTRIC REDUCER G316L A403/A815	7.30
FPWRC300150NBS10G316L	G316L	10S	300NB x 150NB SCH10S (12" x 6")	CONCENTRIC REDUCER G316L A403/A815	6.58
FPWRC300200NBS10G316L	G316L	10S	300NB x 200NB SCH10S (12" x 8")	CONCENTRIC REDUCER G316L A403/A815	7.67
FPWRC300250NBS10G316L	G316L	10S	300NB x 250NB SCH10S (12" x 10")	CONCENTRIC REDUCER G316L A403/A815	7.98
FPWRC350150NBS10G316L	G316L	10S	350NB x 150NB SCH10S (14" x 6")	CONCENTRIC REDUCER G316L A403/A815	13.00
FPWRC350200NBS10G316L	G316L	10S	350NB x 200NB SCH10S (14" x 8")	CONCENTRIC REDUCER G316L A403/A815	13.88
FPWRC350250NBS10G316L	G316L	10S	350NB x 250NB SCH10S (14" x 10")	CONCENTRIC REDUCER G316L A403/A815	14.41
FPWRC350300NBS10G316L	G316L	10S	350NB x 300NB SCH10S (14" x 12")	CONCENTRIC REDUCER G316L A403/A815	16.00
FPWRC400200NBS10G316L	G316L	10S	400NB x 200NB SCH10S (16" x 8")	CONCENTRIC REDUCER G316L A403/A815	17.00
FPWRC400250NBS10G316L	G316L	10S	400NB x 250NB SCH10S (16" x 10")	CONCENTRIC REDUCER G316L A403/A815	17.72



# Butt Weld Fittings

## Concentric Reducers - Welded

**Grades:** 316L  
**Schedule:** 10S, 40S  
**Unit of Supply:** Each

**Certification:** Acc. to  
 ASME SA403 / ASTM A815  
 to ASME B16.9



### FPWRC

Product Code	Grade	Schedule	Product Size (mm)	Description	Weight ea (kg)
FPWRC400300NBS10G316L	G316L	10S	400NB x 300NB SCH10S (16" x 12")	CONCENTRIC REDUCER G316L A403/A815	18.90
FPWRC400350NBS10G316L	G316L	10S	400NB x 350NB SCH10S (16" x 14")	CONCENTRIC REDUCER G316L A403/A815	17.72
FPWRC500300NBS10G316L	G316L	10S	500NB x 300NB SCH10S (20" x 12")	CONCENTRIC REDUCER G316L A403/A815	33.10
FPWRC500400NBS10G316L	G316L	10S	500NB x 400NB SCH10S (20" x 16")	CONCENTRIC REDUCER G316L A403/A815	32.00
FPWRC500450NBS10G316L	G316L	10S	500NB x 450NB SCH10S (20" x 18")	CONCENTRIC REDUCER G316L A403/A815	33.10
FPWRC600300NBS10G316L	G316L	10S	600NB x 300NB SCH10S (24" x 12")	CONCENTRIC REDUCER G316L A403/A815	48.00
FPWRC600400NBS10G316L	G316L	10S	600NB x 400NB SCH10S (24" x 16")	CONCENTRIC REDUCER G316L A403/A815	48.00
FPWRC600450NBS10G316L	G316L	10S	600NB x 450NB SCH10S (24" x 18")	CONCENTRIC REDUCER G316L A403/A815	49.00
FPWRC600500NBS10G316L	G316L	10S	600NB x 500NB SCH10S (24" x 20")	CONCENTRIC REDUCER G316L A403/A815	50.00
FPWRC020015NBS40G316L	G316L	40S	020NB x 015NB SCH40S (3/4" x 1/2")	CONCENTRIC REDUCER G316L A403/A815	0.14
FPWRC025015NBS40G316L	G316L	40S	025NB x 015NB SCH40S (1" x 1/2")	CONCENTRIC REDUCER G316L A403/A815	0.15
FPWRC025020NBS40G316L	G316L	40S	025NB x 020NB SCH40S (1" x 3/4")	CONCENTRIC REDUCER G316L A403/A815	0.15
FPWRC032020NBS40G316L	G316L	40S	032NB x 020NB SCH40S (1-1/4" x 3/4")	CONCENTRIC REDUCER G316L A403/A815	0.44
FPWRC032025NBS40G316L	G316L	40S	032NB x 025NB SCH40S (1-1/4" x 1")	CONCENTRIC REDUCER G316L A403/A815	0.44
FPWRC040020NBS40G316L	G316L	40S	040NB x 020NB SCH40S (1-1/2" x 3/4")	CONCENTRIC REDUCER G316L A403/A815	0.26
FPWRC040025NBS40G316L	G316L	40S	040NB x 025NB SCH40S (1-1/2" x 1")	CONCENTRIC REDUCER G316L A403/A815	0.26
FPWRC040032NBS40G316L	G316L	40S	040NB x 032NB SCH40S (1-1/2" x 1-1/4")	CONCENTRIC REDUCER G316L A403/A815	0.26
FPWRC050020NBS40G316L	G316L	40S	050NB x 020NB SCH40S (2" x 3/4")	CONCENTRIC REDUCER G316L A403/A815	0.45
FPWRC050025NBS40G316L	G316L	40S	050NB x 025NB SCH40S (2" x 1")	CONCENTRIC REDUCER G316L A403/A815	0.45
FPWRC050032NBS40G316L	G316L	40S	050NB x 032NB SCH40S (2" x 1-1/4")	CONCENTRIC REDUCER G316L A403/A815	0.22
FPWRC050040NBS40G316L	G316L	40S	050NB x 040NB SCH40S (2" x 1-1/2")	CONCENTRIC REDUCER G316L A403/A815	0.45
FPWRC065040NBS40G316L	G316L	40S	065NB x 040NB SCH40S (2-1/2" x 1-1/2")	CONCENTRIC REDUCER G316L A403/A815	0.77
FPWRC065050NBS40G316L	G316L	40S	065NB x 050NB SCH40S (2-1/2" x 2")	CONCENTRIC REDUCER G316L A403/A815	0.77
FPWRC080025NBS40G316L	G316L	40S	080NB x 025NB SCH40S (3" x 1")	CONCENTRIC REDUCER G316L A403/A815	0.89
FPWRC080040NBS40G316L	G316L	40S	080NB x 040NB SCH40S (3" x 1-1/2")	CONCENTRIC REDUCER G316L A403/A815	0.89
FPWRC080050NBS40G304L	G316L	40S	080NB x 050NB SCH40S (3" x 2")	CONCENTRIC REDUCER G316L A403/A815	0.89
FPWRC080050NBS40G316L	G316L	40S	080NB x 050NB SCH40S (3" x 2")	CONCENTRIC REDUCER G316L A403/A815	0.89
FPWRC080065NBS40G316L	G316L	40S	080NB x 065NB SCH40S (3" x 2-1/2")	CONCENTRIC REDUCER G316L A403/A815	1.74
FPWRC100050NBS40G316L	G316L	40S	100NB x 050NB SCH40S (4" x 2")	CONCENTRIC REDUCER G316L A403/A815	1.74
FPWRC100065NBS40G316L	G316L	40S	100NB x 065NB SCH40S (4" x 2-1/2")	CONCENTRIC REDUCER G316L A403/A815	1.74
FPWRC100080NBS40G316L	G316L	40S	100NB x 080NB SCH40S (4" x 3")	CONCENTRIC REDUCER G316L A403/A815	2.85
FPWRC125080NBS40G316L	G316L	40S	125NB x 080NB SCH40S (5" x 3")	CONCENTRIC REDUCER G316L A403/A815	2.85
FPWRC125100NBS40G316L	G316L	40S	125NB x 100NB SCH40S (5" x 4")	CONCENTRIC REDUCER G316L A403/A815	4.08
FPWRC150080NBS40G316L	G316L	40S	150NB x 080NB SCH40S (6" x 3")	CONCENTRIC REDUCER G316L A403/A815	4.08
FPWRC150100NBS40G316L	G316L	40S	150NB x 100NB SCH40S (6" x 4")	CONCENTRIC REDUCER G316L A403/A815	4.08
FPWRC150125NBS40G316L	G316L	40S	150NB x 125NB SCH40S (6" x 5")	CONCENTRIC REDUCER G316L A403/A815	6.94
FPWRC200100NBS40G316L	G316L	40S	200NB x 100NB SCH40S (8" x 4")	CONCENTRIC REDUCER G316L A403/A815	6.55
FPWRC200150NBS40G316L	G316L	40S	200NB x 150NB SCH40S (8" x 6")	CONCENTRIC REDUCER G316L A403/A815	11.56
FPWRC250150NBS40G316L	G316L	40S	250NB x 150NB SCH40S (10" x 6")	CONCENTRIC REDUCER G316L A403/A815	11.56
FPWRC250200NBS40G316L	G316L	40S	250NB x 200NB SCH40S (10" x 8")	CONCENTRIC REDUCER G316L A403/A815	16.63
FPWRC300200NBS40G316L	G316L	40S	300NB x 200NB SCH40S (12" x 8")	CONCENTRIC REDUCER G316L A403/A815	15.98
FPWRC300250NBS40G316L	G316L	40S	300NB x 250NB SCH40S (12" x 10")	CONCENTRIC REDUCER G316L A403/A815	15.98

# Butt Weld Fittings

## Eccentric Reducers - Welded

**Grades:** 316L  
**Schedule:** 10S, 40S  
**Unit of Supply:** Each

**Certification:** Acc. to  
 ASME SA403 / ASTM A815  
 to ASME B16.9



### FPWRE

Product Code	Grade	Schedule	Product Size (mm)	Description	Weight ea (kg)
FPWRE025020NBS10G316L	G316L	10S	025NB x 020NB SCH10S (1" x 3/4")	ECCENTRIC REDUCER G316L A403/A815	0.13
FPWRE040020NBS10G316L	G316L	10S	040NB x 020NB SCH10S (1-1/2" x 3/4")	ECCENTRIC REDUCER G316L A403/A815	0.20
FPWRE040025NBS10G316L	G316L	10S	040NB x 025NB SCH10S (1-1/2" x 1")	ECCENTRIC REDUCER G316L A403/A815	0.20
FPWRE040032NBS10G316L	G316L	10S	040NB x 032NB SCH10S (1-1/2" x 1-1/4")	ECCENTRIC REDUCER G316L A403/A815	0.20
FPWRE050025NBS10G316L	G316L	10S	050NB x 025NB SCH10S (2" x 1")	ECCENTRIC REDUCER G316L A403/A815	0.30
FPWRE050032NBS10G316L	G316L	10S	050NB x 032NB SCH10S (2" x 1-1/4")	ECCENTRIC REDUCER G316L A403/A815	0.30
FPWRE050040NBS10G316L	G316L	10S	050NB x 040NB SCH10S (2" x 1-1/2")	ECCENTRIC REDUCER G316L A403/A815	0.30
FPWRE065040NBS10G316L	G316L	10S	065NB x 040NB SCH10S (2-1/2" x 1-1/2")	ECCENTRIC REDUCER G316L A403/A815	0.31
FPWRE065050NBS10G316L	G316L	10S	065NB x 050NB SCH10S (2-1/2" x 2")	ECCENTRIC REDUCER G316L A403/A815	0.31
FPWRE080040NBS10G316L	G316L	10S	080NB x 040NB SCH10S (3" x 1-1/2")	ECCENTRIC REDUCER G316L A403/A815	0.51
FPWRE080050NBS10G316L	G316L	10S	080NB x 050NB SCH10S (3" x 2")	ECCENTRIC REDUCER G316L A403/A815	0.55
FPWRE080065NBS10G316L	G316L	10S	080NB x 065NB SCH10S (3" x 2-1/2")	ECCENTRIC REDUCER G316L A403/A815	0.55
FPWRE100050NBS10G316L	G316L	10S	100NB x 050NB SCH10S (4" x 2")	ECCENTRIC REDUCER G316L A403/A815	0.83
FPWRE100065NBS10G316L	G316L	10S	100NB x 065NB SCH10S (4" x 2-1/2")	ECCENTRIC REDUCER G316L A403/A815	0.78
FPWRE100080NBS10G316L	G316L	10S	100NB x 080NB SCH10S (4" x 3")	ECCENTRIC REDUCER G316L A403/A815	0.83
FPWRE150080NBS10G316L	G316L	10S	150NB x 080NB SCH10S (6" x 3")	ECCENTRIC REDUCER G316L A403/A815	1.82
FPWRE150100NBS10G316L	G316L	10S	150NB x 100NB SCH10S (6" x 4")	ECCENTRIC REDUCER G316L A403/A815	1.95
FPWRE250150NBS10G316L	G316L	10S	250NB x 150NB SCH10S (10" x 6")	ECCENTRIC REDUCER G316L A403/A815	11.12
FPWRE250200NBS10G316L	G316L	10S	250NB x 200NB SCH10S (10" x 8")	ECCENTRIC REDUCER G316L A403/A815	5.00
FPWRE300150NBS10G316L	G316L	10S	300NB x 150NB SCH10S (12" x 6")	ECCENTRIC REDUCER G316L A403/A815	7.67
FPWRE300200NBS10G316L	G316L	10S	300NB x 200NB SCH10S (12" x 8")	ECCENTRIC REDUCER G316L A403/A815	7.98
FPWRE300250NBS10G316L	G316L	10S	300NB x 250NB SCH10S (12" x 10")	ECCENTRIC REDUCER G316L A403/A815	7.98
FPWRE350200NBS10G316L	G316L	10S	350NB x 200NB SCH10S (14" x 8")	ECCENTRIC REDUCER G316L A403/A815	15.00
FPWRE350250NBS10G316L	G316L	10S	350NB x 250NB SCH10S (14" x 10")	ECCENTRIC REDUCER G316L A403/A815	15.00
FPWRE350300NBS10G316L	G316L	10S	350NB x 300NB SCH10S (14" x 12")	ECCENTRIC REDUCER G316L A403/A815	16.00
FPWRE400200NBS10G316L	G316L	10S	400NB x 200NB SCH10S (16" x 8")	ECCENTRIC REDUCER G316L A403/A815	17.40
FPWRE400250NBS10G316L	G316L	10S	400NB x 250NB SCH10S (16" x 10")	ECCENTRIC REDUCER G316L A403/A815	17.40
FPWRE400300NBS10G316L	G316L	10S	400NB x 300NB SCH10S (16" x 12")	ECCENTRIC REDUCER G316L A403/A815	17.50
FPWRE400350NBS10G316L	G316L	10S	400NB x 350NB SCH10S (16" x 14")	ECCENTRIC REDUCER G316L A403/A815	17.70
FPWRE450300NBS10G316L	G316L	10S	450NB x 300NB SCH10S (18" x 12")	ECCENTRIC REDUCER G316L A403/A815	21.00
FPWRE450350NBS10G316L	G316L	10S	450NB x 350NB SCH10S (18" x 14")	ECCENTRIC REDUCER G316L A403/A815	21.00
FPWRE450400NBS10G316L	G316L	10S	450NB x 400NB SCH10S (18" x 16")	ECCENTRIC REDUCER G316L A403/A815	21.00
FPWRE500300NBS10G316L	G316L	10S	500NB x 300NB SCH10S (20" x 12")	ECCENTRIC REDUCER G316L A403/A815	34.00
FPWRE500350NBS10G316L	G316L	10S	500NB x 350NB SCH10S (20" x 14")	ECCENTRIC REDUCER G316L A403/A815	34.00
FPWRE500400NBS10G316L	G316L	10S	500NB x 400NB SCH10S (20" x 16")	ECCENTRIC REDUCER G316L A403/A815	35.00
FPWRE500450NBS10G316L	G316L	10S	500NB x 450NB SCH10S (20" x 18")	ECCENTRIC REDUCER G316L A403/A815	36.00
FPWRE600400NBS10G316L	G316L	10S	600NB x 400NB SCH10S (24" x 16")	ECCENTRIC REDUCER G316L A403/A815	48.00
FPWRE600450NBS10G316L	G316L	10S	600NB x 450NB SCH10S (24" x 18")	ECCENTRIC REDUCER G316L A403/A815	49.00
FPWRE600500NBS10G316L	G316L	10S	600NB x 500NB SCH10S (24" x 20")	ECCENTRIC REDUCER G316L A403/A815	50.00
FPWRE750450NBS10G316L	G316L	10S	750NB x 450NB SCH10S (30" x 18")	ECCENTRIC REDUCER G316L A403/A815	75.00
FPWRE750500NBS10G316L	G316L	10S	750NB x 500NB SCH10S (30" x 20")	ECCENTRIC REDUCER G316L A403/A815	78.00
FPWRE750600NBS10G316L	G316L	10S	750NB x 600NB SCH10S (30" x 24")	ECCENTRIC REDUCER G316L A403/A815	93.00

# Butt Weld Fittings

## Eccentric Reducers - Welded

**Grades:** 316L  
**Schedule:** 10S, 40S  
**Unit of Supply:** Each

**Certification:** Acc. to  
 ASME SA403 / ASTM A815  
 to ASME B16.9



### FPWRE

Product Code	Grade	Schedule	Product Size (mm)	Description	Weight ea (kg)
FPWRE020015NBS40G316L	G316L	40S	020NB x 015NB SCH40S (3/4" x 1/2")	ECCENTRIC REDUCER G316L A403/A815	0.14
FPWRE025020NBS40G316L	G316L	40S	025NB x 020NB SCH40S (1" x 3/4")	ECCENTRIC REDUCER G316L A403/A815	0.16
FPWRE040020NBS40G316L	G316L	40S	040NB x 020NB SCH40S (1-1/2" x 3/4")	ECCENTRIC REDUCER G316L A403/A815	0.28
FPWRE040025NBS40G316L	G316L	40S	040NB x 025NB SCH40S (1-1/2" x 1")	ECCENTRIC REDUCER G316L A403/A815	0.26
FPWRE040032NBS40G316L	G316L	40S	040NB x 032NB SCH40S (1-1/2" x 1-1/4")	ECCENTRIC REDUCER G316L A403/A815	0.26
FPWRE050025NBS40G316L	G316L	40S	050NB x 025NB SCH40S (2" x 1")	ECCENTRIC REDUCER G316L A403/A815	0.40
FPWRE050032NBS40G316L	G316L	40S	050NB x 032NB SCH40S (2" x 1-1/4")	ECCENTRIC REDUCER G316L A403/A815	0.40
FPWRE050040NBS40G316L	G316L	40S	050NB x 040NB SCH40S (2" x 1-1/2")	ECCENTRIC REDUCER G316L A403/A815	0.40
FPWRE065040NBS40G316L	G316L	40S	065NB x 040NB SCH40S (2-1/2" x 1-1/2")	ECCENTRIC REDUCER G316L A403/A815	0.45
FPWRE065050NBS40G316L	G316L	40S	065NB x 050NB SCH40S (2-1/2" x 2")	ECCENTRIC REDUCER G316L A403/A815	0.45
FPWRE080040NBS40G316L	G316L	40S	080NB x 040NB SCH40S (3" x 1-1/2")	ECCENTRIC REDUCER G316L A403/A815	0.89
FPWRE080050NBS40G316L	G316L	40S	080NB x 050NB SCH40S (3" x 2")	ECCENTRIC REDUCER G316L A403/A815	0.89
FPWRE080065NBS40G316L	G316L	40S	080NB x 065NB SCH40S (3" x 2-1/2")	ECCENTRIC REDUCER G316L A403/A815	0.89
FPWRE100050NBS40G316L	G316L	40S	100NB x 050NB SCH40S (4" x 2")	ECCENTRIC REDUCER G316L A403/A815	1.66
FPWRE100065NBS40G316L	G316L	40S	100NB x 065NB SCH40S (4" x 2-1/2")	ECCENTRIC REDUCER G316L A403/A815	1.66
FPWRE100080NBS40G316L	G316L	40S	100NB x 080NB SCH40S (4" x 3")	ECCENTRIC REDUCER G316L A403/A815	1.66

# Butt Weld Fittings

## Stub Ends - Short Length

**Grades:** 316L  
**Schedule:** 10S, 40S  
**Unit of Supply:** Each  
 (For use with lapjoint flanges)

**Certification:** Acc. to  
 ASTM SA403 / ASTM A815 MSS-SP43/ Type  
 A, ASME B16.9/ 93 Short Pattern



### FPWSE

Product Code	Grade	Schedule	Product Size (mm)	Description	Weight ea (kg)
FPWSE025NBS10G316L	G316L	10S	025NB SCH10S (1")	BUTT WELD STUB END G316L A403/A815	0.16
FPWSE032NBS10G316L	G316L	10S	032NB SCH10S (1-1/4")	BUTT WELD STUB END G316L A403/A815	0.22
FPWSE040NBS10G316L	G316L	10S	040NB SCH10S (1-1/2")	BUTT WELD STUB END G316L A403/A815	0.25
FPWSE050NBS10G316L	G316L	10S	050NB SCH10S (2")	BUTT WELD STUB END G316L A403/A815	0.43
FPWSE065NBS10G316L	G316L	10S	065NB SCH10S (2-1/2")	BUTT WELD STUB END G316L A403/A815	0.57
FPWSE080NBS10G316L	G316L	10S	080NB SCH10S (3")	BUTT WELD STUB END G316L A403/A815	0.73
FPWSE100NBS10G316L	G316L	10S	100NB SCH10S (4")	BUTT WELD STUB END G316L A403/A815	1.09
FPWSE015NBS40G316L	G316L	40S	015NB SCH40S (1/2")	BUTT WELD STUB END G316L A403/A815	0.09
FPWSE025NBS40G316L	G316L	40S	025NB SCH40S (1")	BUTT WELD STUB END G316L A403/A815	0.17
FPWSE032NBS40G316L	G316L	40S	032NB SCH40S (1-1/4")	BUTT WELD STUB END G316L A403/A815	0.25
FPWSE040NBS40G316L	G316L	40S	040NB SCH40S (1-1/2")	BUTT WELD STUB END G316L A403/A815	0.31
FPWSE065NBS40G316L	G316L	40S	065NB SCH40S (2-1/2")	BUTT WELD STUB END G316L A403/A815	0.80
FPWSE080NBS40G316L	G316L	40S	080NB SCH40S (3")	BUTT WELD STUB END G316L A403/A815	1.13
FPWSE100NBS40G316L	G316L	40S	100NB SCH40S (4")	BUTT WELD STUB END G316L A403/A815	1.87
FPWSE150NBS40G316L	G316L	40S	150NB SCH40S (6")	BUTT WELD STUB END G316L A403/A815	3.57

## Neck Rings

**Grades:** 316L  
**Schedule:** 10S, 40S

**Unit of Supply:** Each  
**Certification:** Acc. to ASTM A240/480



### FPWNR

Product Code	Grade	Schedule	Product Size (mm)	Description	Weight ea (kg)
FPWNR015NBS10S	G316	10S	15 NB SCH10S	NECK RING PIPE G316	0.48
FPWNR020NBS10S	G316	10S	20 NB SCH10S	NECK RING PIPE G316	0.69
FPWNR025NBS10S	G316	10S	25 NB SCH10S	NECK RING PIPE G316	0.97
FPWNR032NBS10S	G316	10S	32 NB SCH10S	NECK RING PIPE G316	0.13
FPWNR040NBS10S	G316	10S	40 NB SCH10S	NECK RING PIPE G316	0.15
FPWNR050NBS10S	G316	10S	50 NB SCH10S	NECK RING PIPE G316	0.23
FPWNR065NBS10S	G316	10S	65 NB SCH10S	NECK RING PIPE G316	0.29
FPWNR080NBS10S	G316	10S	80 NB SCH10S	NECK RING PIPE G316	0.37
FPWNR100NBS10S	G316	10S	100 NB SCH10S	NECK RING PIPE G316	0.60
FPWNR125NBS10S	G316	10S	125 NB SCH10S	NECK RING PIPE G316	0.82
FPWNR150NBS10S	G316	10S	150 NB SCH10S	NECK RING PIPE G316	0.93
FPWNR200NBS10S	G316	10S	200 NB SCH10S	NECK RING PIPE G316	1.28
FPWNR250NBS10S	G316	10S	250 NB SCH10S	NECK RING PIPE G316	1.72
FPWNR300NBS10S	G316	10S	300 NB SCH10S	NECK RING PIPE G316	2.51
FPWNR350NBS10S	G316	10S	350 NB SCH10S	NECK RING PIPE G316	3.11
FPWNR400NBS10S	G316	10S	400 NB SCH10S	NECK RING PIPE G316	3.96
FPWNR450NBS10S	G316	10S	450 NB SCH10S	NECK RING PIPE G316	4.50
FPWNR500NBS10S	G316	10S	500 NB SCH10S	NECK RING PIPE G316	5.40

SCH40S available on request also. Typically used in tandem with galv back up flanges.

# Butt Weld Fittings

## End Caps – Seamless

**Grades:** 316L  
**Schedule:** 10S, 40S  
**Unit of Supply:** Each

**Certification:** Acc. to  
 ASME SA403 / ASTM A815 to ASME B16.9



### FPSEC

Product Code	Grade	Schedule	Product Size (mm)	Description	Weight ea (kg)
FPSEC015NBS10G316L	G316L	10S	015NB SCH10S (1/2")	BUTT WELD END CAP G316L A403/A815	0.04
FPSEC020NBS10G316L	G316L	10S	020NB SCH10S (3/4")	BUTT WELD END CAP G316L A403/A815	0.05
FPSEC025NBS10G316L	G316L	10S	025NB SCH10S (1")	BUTT WELD END CAP G316L A403/A815	0.09
FPSEC032NBS10G316L	G316L	10S	032NB SCH10S (1-1/4")	BUTT WELD END CAP G316L A403/A815	0.13
FPSEC040NBS10G316L	G316L	10S	040NB SCH10S (1-1/2")	BUTT WELD END CAP G316L A403/A815	0.14
FPSEC050NBS10G316L	G316L	10S	050NB SCH10S (2")	BUTT WELD END CAP G316L A403/A815	0.17
FPSEC065NBS10G316L	G316L	10S	065NB SCH10S (2-1/2")	BUTT WELD END CAP G316L A403/A815	0.25
FPSEC080NBS10G316L	G316L	10S	080NB SCH10S (3")	BUTT WELD END CAP G316L A403/A815	0.40
FPSEC100NBS10G316L	G316L	10S	100NB SCH10S (4")	BUTT WELD END CAP G316L A403/A815	0.65
FPSEC125NBS10G316L	G316L	10S	125NB SCH10S (5")	BUTT WELD END CAP G316L A403/A815	1.02
FPSEC150NBS10G316L	G316L	10S	150NB SCH10S (6")	BUTT WELD END CAP G316L A403/A815	1.36
FPSEC200NBS10G316L	G316L	10S	200NB SCH10S (8")	BUTT WELD END CAP G316L A403/A815	2.49
FPSEC250NBS10G316L	G316L	10S	250NB SCH10S (10")	BUTT WELD END CAP G316L A403/A815	4.90
FPSEC300NBS10G316L	G316L	10S	300NB SCH10S (12")	BUTT WELD END CAP G316L A403/A815	6.53
FPSEC400NBS10G316L	G316L	10S	400NB SCH10S (16")	BUTT WELD END CAP G316L A403/A815	14.51
FPSEC450NBS10G316L	G316L	10S	450NB SCH10S (18")	BUTT WELD END CAP G316L A403/A815	17.96
FPSEC500NBS10G316L	G316L	10S	500NB SCH10S (20")	BUTT WELD END CAP G316L A403/A815	27.22
FPSEC015NBS40G316L	G316L	40S	015NB SCH40S (1/2")	BUTT WELD END CAP G316L A403/A815	0.05
FPSEC020NBS40G316L	G316L	40S	020NB SCH40S (3/4")	BUTT WELD END CAP G316L A403/A815	0.06
FPSEC025NBS40G316L	G316L	40S	025NB SCH40S (1")	BUTT WELD END CAP G316L A403/A815	0.13
FPSEC032NBS40G316L	G316L	40S	032NB SCH40S (1-1/4")	BUTT WELD END CAP G316L A403/A815	0.17
FPSEC040NBS40G316L	G316L	40S	040NB SCH40S (1-1/2")	BUTT WELD END CAP G316L A403/A815	0.23
FPSEC050NBS40G316L	G316L	40S	050NB SCH40S (2")	BUTT WELD END CAP G316L A403/A815	0.27
FPSEC065NBS40G316L	G316L	40S	065NB SCH40S (2-1/2")	BUTT WELD END CAP G316L A403/A815	0.45
FPSEC080NBS40G316L	G316L	40S	080NB SCH40S (3")	BUTT WELD END CAP G316L A403/A815	0.71
FPSEC100NBS40G316L	G316L	40S	100NB SCH40S (4")	BUTT WELD END CAP G316L A403/A815	1.22
FPSEC125NBS40G316L	G316L	40S	125NB SCH40S (5")	BUTT WELD END CAP G316L A403/A815	1.91
FPSEC150NBS40G316L	G316L	40S	150NB SCH40S (6")	BUTT WELD END CAP G316L A403/A815	3.23
FPSEC200NBS40G316L	G316L	40S	200NB SCH40S (8")	BUTT WELD END CAP G316L A403/A815	5.67
FPSEC250NBS40G316L	G316L	40S	250NB SCH40S (10")	BUTT WELD END CAP G316L A403/A815	9.21
FPSEC300NBS40G316L	G316L	40S	300NB SCH40S (12")	BUTT WELD END CAP G316L A403/A815	13.06